

T. 5N. R. 29E. W.M.

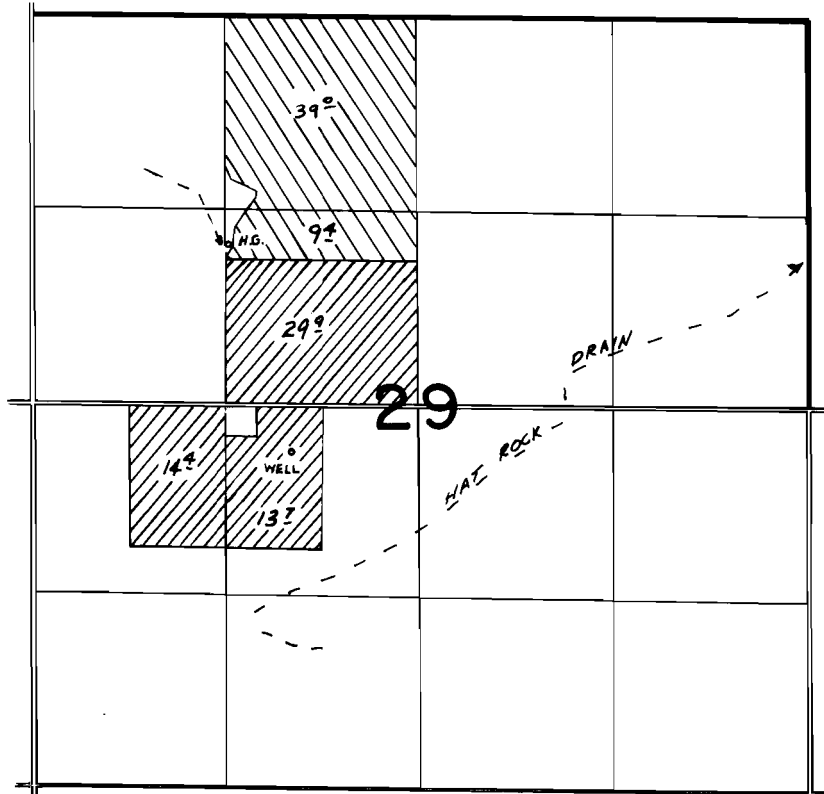

WELL LOC. 320'S & 1770'E FROM W1/4 COR. SEC 29



*Supplemental*



*Primary*

**FINAL PROOF SURVEY**  
UNDER

Application No. G-6438... Permit No. G-6041...  
IN NAME OF

**JOHNNIE M. MAYES**

Surveyed 10-21 1978, by R. BARWIN