

T7N & T8N, R5W & R6W, WM  
 CLATSOP COUNTY  
 COLUMBIA COUNTY

POINT OF DIVISION: 322.17' N. & 220.86' E. OF 1/4 CORNER 1 & 6,  
**FINAL PROOF SURVEY**  
 UNDER

**WESTPORT WATER ASSOCIATION**

APPLICATION NO. 5-72378  
 4183  
 PREPARED BY: 32448  
 3088  
 CERTIFICATE NO. 36201  
 TRAMPER NO. 1-4728

NOVEMBER 24, 2002  
 SCALE 1" = 120'

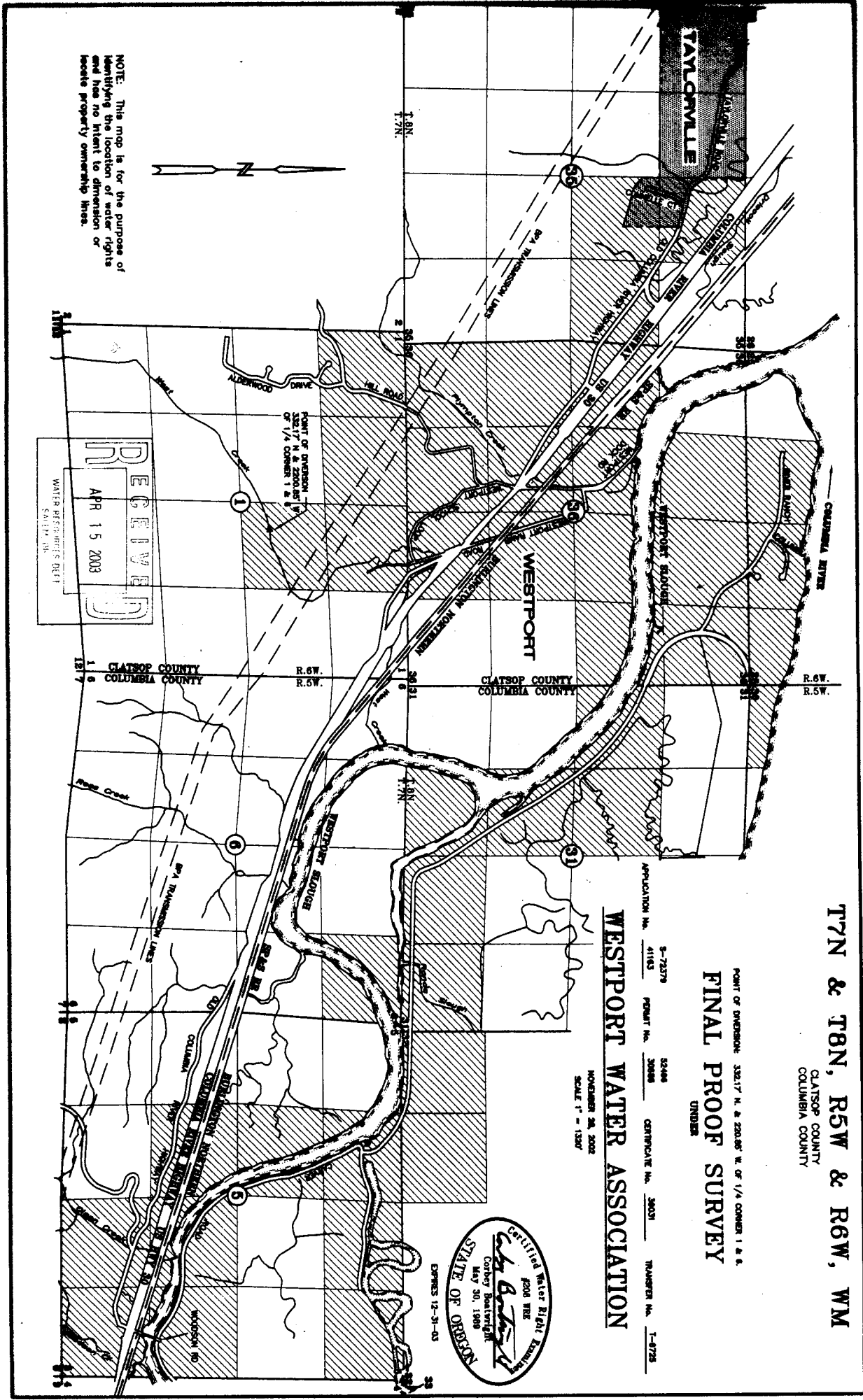
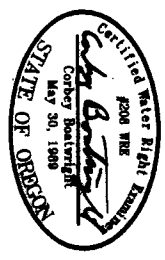

NOTE: This map is for the purpose of identifying the location of water rights and has no intent to determine or locate property ownership lines.

**RECEIVED**  
 APR 15 2003  
 WATER RESOURCES DEPT  
 SALEM, OR