

CLAIM OF BENEFICIAL USE MAP

UNDER APPLICATION R-83414 ; PERMIT R-12366

SW1/4 NE1/4 SEC 32 T 27S R 44E W.M.

U.S.G.S. QUAD - MCCAIN CREEK, OREG. - 7 1/2'

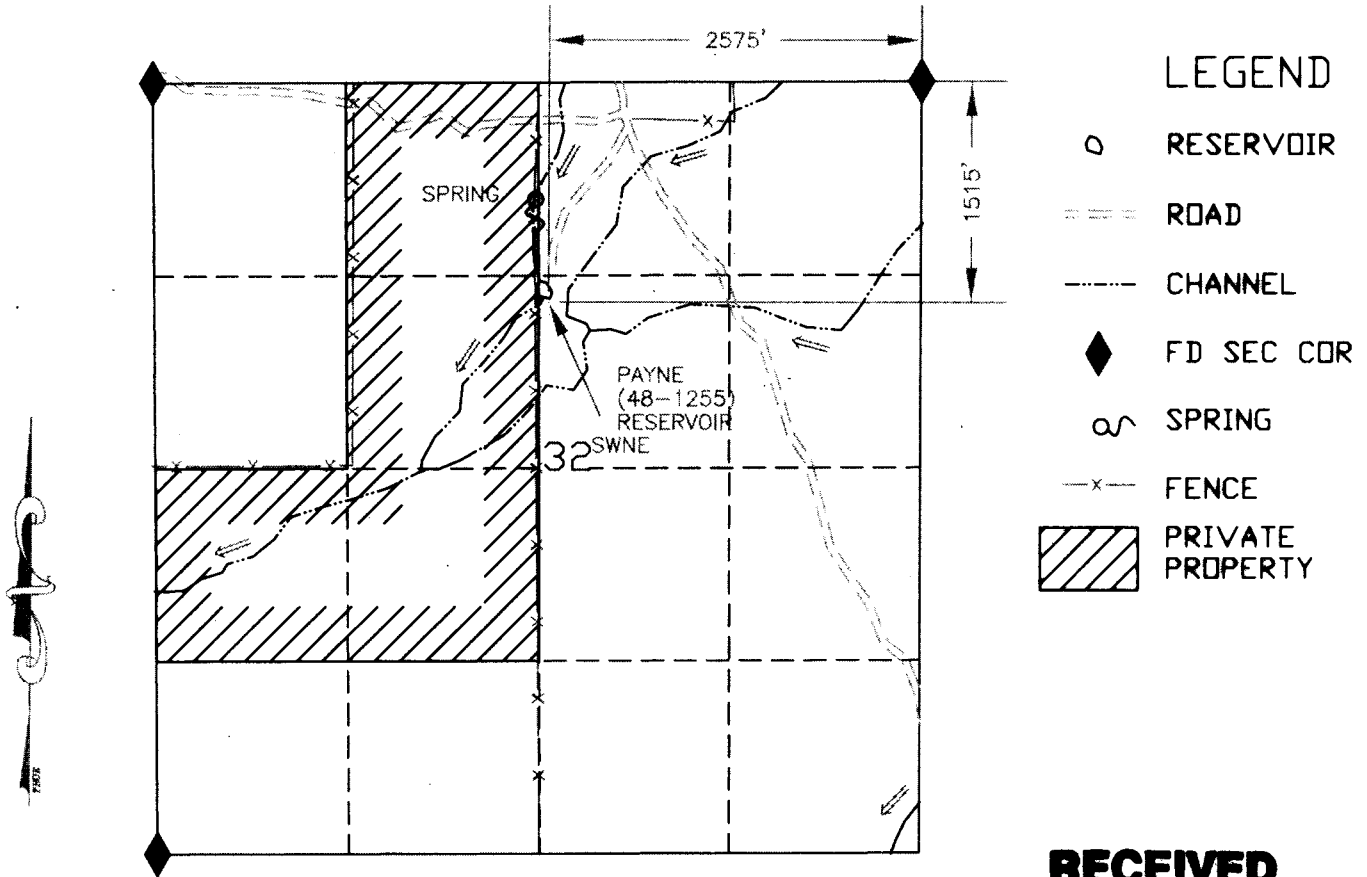

RECEIVED

DEC 09 2002

WATER RESOURCES DEPT.
SALEM, OREGON

PAYNE (48-1255) RESERVOIR

1320 660 0 1320

SCALE 1"=1320'

Thomas Terry

Thomas Terry ADM Operations/Field Services agree to the findings of the CWRE and do submit this site report and map as my Claim of Beneficial Use of the water as provided under the terms and conditions of my Permit R-12366



UNITED STATES DEPARTMENT OF THE INTERIOR
BUREAU OF LAND MANAGEMENT
DIVISION OF OPERATIONS VALE DISTRICT

PAYNE (48-1255)
RESERVOIR

DRAWN BY: *James R. Johnson*
SURVEYED: *Thomas Terry*
APPROVED: *Thomas Terry*

DRAWN: CG SCALE: 1"=1320'

DATE: 11/08/01 SHEET 1 OF 1

DRAWING NO. OR-03-9172.45-1110

THIS MAP IS FOR THE PURPOSE OF LOCATING A WATER RIGHT AND IS NOT INTENDED TO PROVIDE LEGAL DIMENSIONS FOR LOCATION OF PROPERTY BOUNDARIES.

ACAB2000
DWG FILE: PAYNEADEN