

T 34S R 6W S 36

RECEIVED

RECEIVED

NOV 15 2001

SEP 20 1999

WATER RESOURCES DEPT
SALEM, OREGON

WATER RESOURCES DEPT
SALEM, OREGON

SEE MAP 34

Prepared for
purpose only.

N ↑

1" = 400'

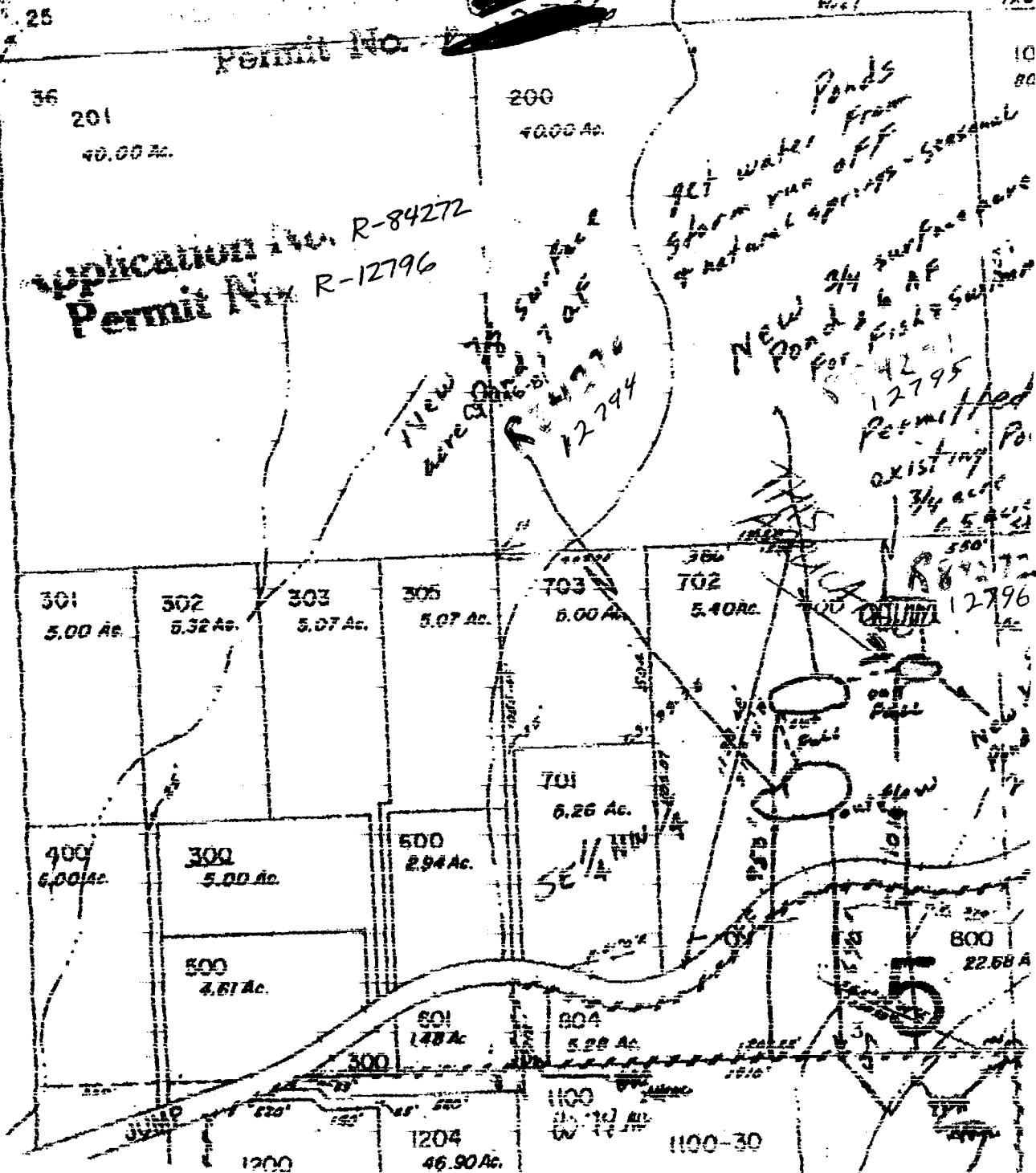

25

36

201

40.00 Ac.

200

40.00 Ac.

Application No. R-84272
Permit No. R-12796

New 3/4 surface water pond
Permit No. R-12796

get water from storm run off & natural springs - seasonal

New 3/4 surface pond & 2 1/2 AF fish & wildlife pond

Permitted existing pond 3/4 acre 6.5 acres

301

5.00 Ac.

302

5.32 Ac.

303

5.07 Ac.

305

5.07 Ac.

703

6.00 Ac.

702

5.40 Ac.

701

6.26 Ac.

400

6.00 Ac.

300

5.00 Ac.

500

2.94 Ac.

500

4.61 Ac.

501

1.48 Ac.

804

5.28 Ac.

1204

46.90 Ac.

800

22.68 Ac.

1100

1100-30

1100-30

JUMP

1200

LH
sect 36