

UNITED STATES
DEPARTMENT OF THE INTERIOR
BUREAU OF LAND MANAGEMENT

SECTION

35
NW 1/4 NW 1/4

Oregon State Water Filings

TOWNSHIP 40S, RANGE 4E, W. M.

Fall Creek Res.

North

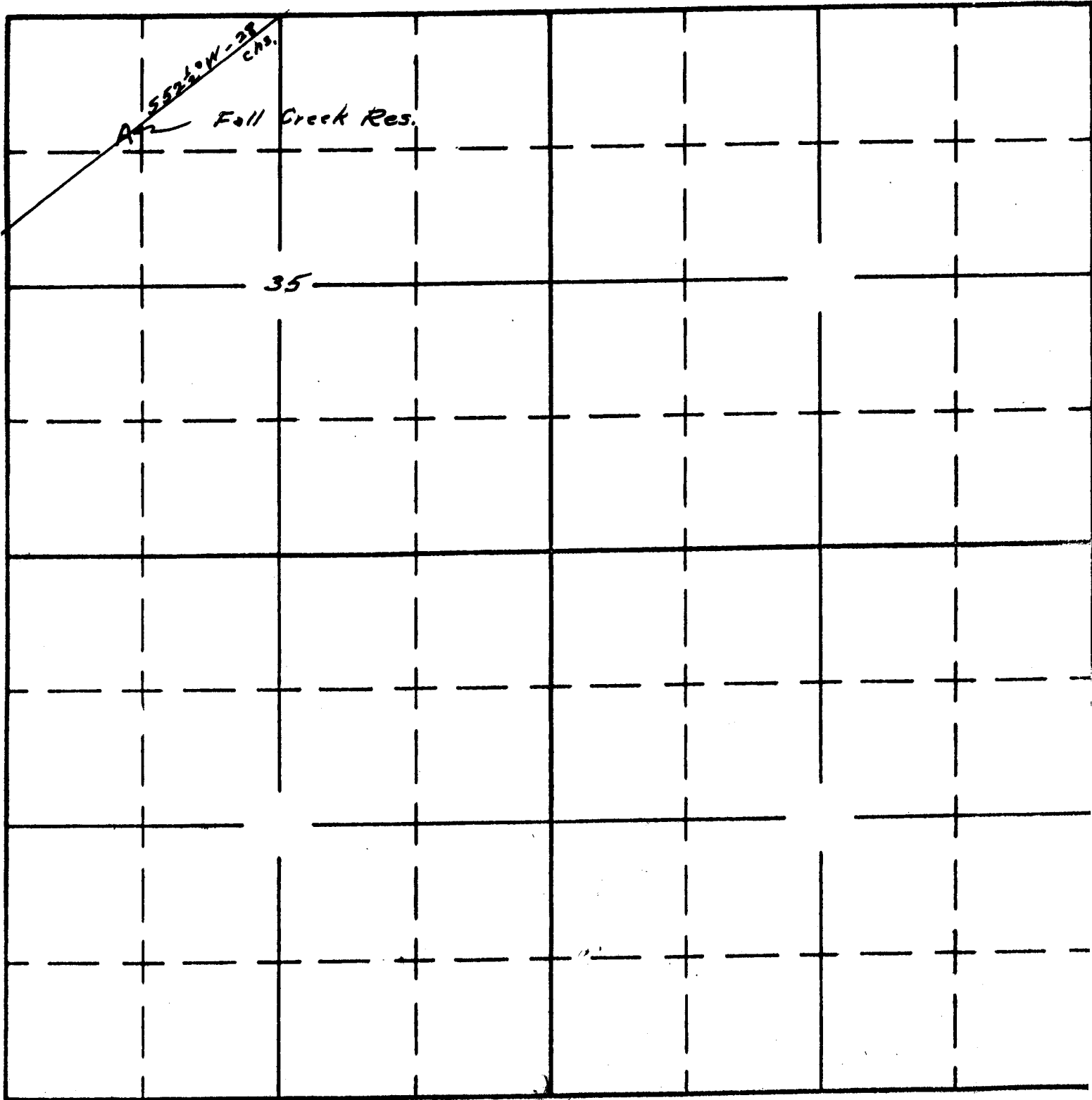

South

APPLICATION No. R-3521
PERMIT No. R-323