

Final proof survey under  
 Application number: R32085 Permit number: R2283  
 Application number: S32086 Permit number: S26397  
 Application number: R48694 Permit number: R5755  
 Application number: S48695 Permit number: S35718

This map was prepared for the purpose of identifying the location of the water right only. It is not intended to provide legal dimensions or location of property ownership lines.

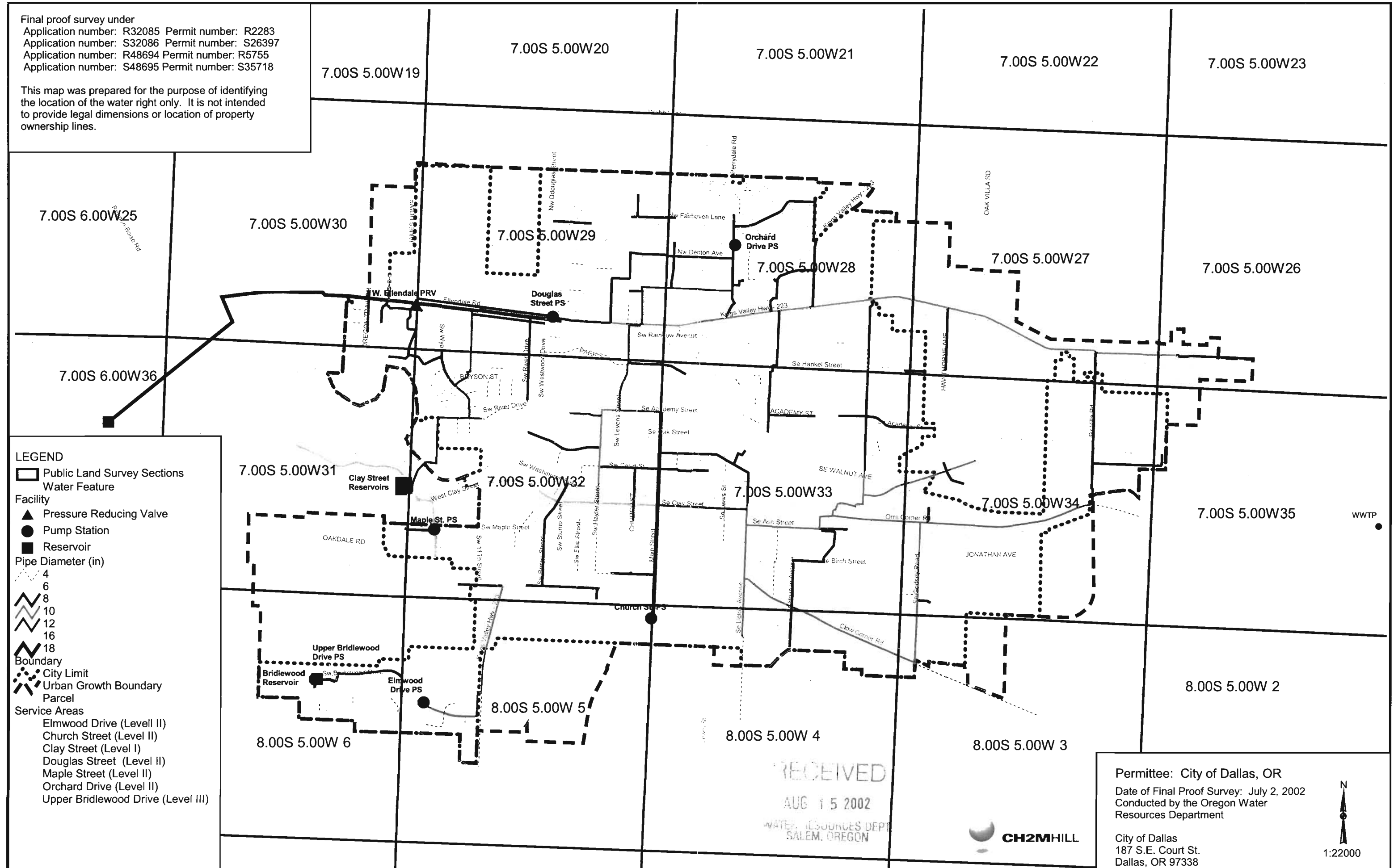

- LEGEND**
- Public Land Survey Sections
  - Water Feature
  - Facility**
  - Pressure Reducing Valve
  - Pump Station
  - Reservoir
  - Pipe Diameter (in)**
  - 4
  - 6
  - 8
  - 10
  - 12
  - 16
  - 18
  - Boundary**
  - City Limit
  - Urban Growth Boundary
  - Parcel
  - Service Areas**
  - Elmwood Drive (Level II)
  - Church Street (Level II)
  - Clay Street (Level I)
  - Douglas Street (Level II)
  - Maple Street (Level II)
  - Orchard Drive (Level II)
  - Upper Bridlewood Drive (Level III)

RECEIVED  
 AUG 15 2002  
 WATER RESOURCES DEPT  
 SALEM, OREGON



Permittee: City of Dallas, OR  
 Date of Final Proof Survey: July 2, 2002  
 Conducted by the Oregon Water Resources Department

City of Dallas  
 187 S.E. Court St.  
 Dallas, OR 97338



*do not remove - file copy*

**WATER TRANSMISSION LINE  
OVERALL PLAN AND PROFILE  
VICINITY MAP**

SCALE: AS SHOWN DATE: APRIL 6 1953 SHEET 1 OF 9  
DES. HAC DR. AC TR. CK. HAC  
**CORNELL, HOWLAND, HAYES & MERRYFIELD**  
CONSULTING ENGINEERS  
CORVALLIS, OREGON  
DWG. NO. **C4774**



**ACCESS ROADS**  
Between Station 42+73.00 and Station 77+59.50 the right of ingress and egress to and from the pipeline has been obtained from the owner only through the lane which intersects the pipeline at Sta. 63+79.31. The right of ingress and egress to all other portions of the pipeline has been obtained from the property owners. Damages to private property during such ingress and egress shall be indemnified as specified.

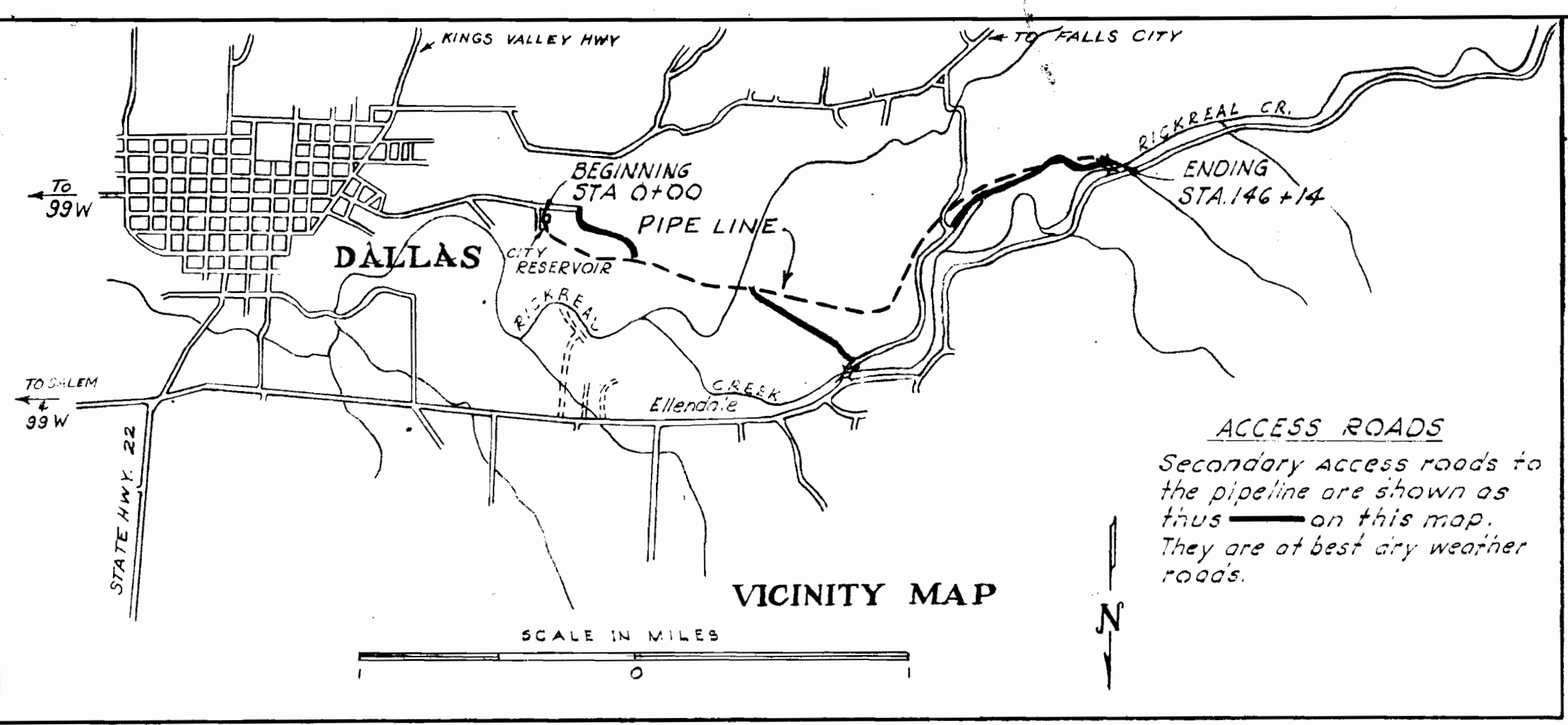

**ACCESS ROADS**  
Secondary access roads to the pipeline are shown as      on this map. They are of best dry weather roads.

RANGE 5 WEST  
RANGE 6 WEST

U  
O  
I  
V  
R  
I  
T  
R  
S  
D  
O  
I  
R  
O  
I

