

T.24S., R.18E., W.M.

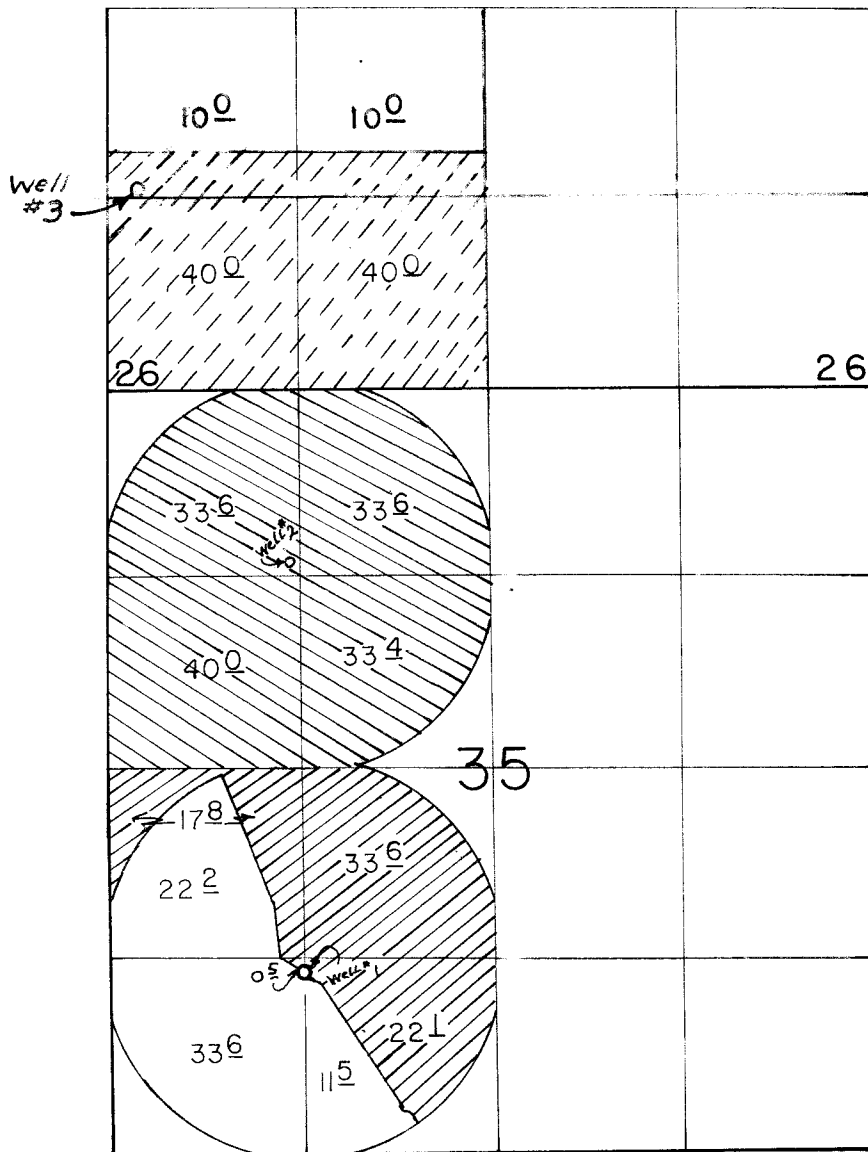

WELL 1, 1250' N & 1320' E FROM SW COR. OF SEC 35.
 WELL 2, 1200' S & 1250' E FROM NW COR. OF SEC 35.
 WELL 3, 1360' N & 200' E FROM SW COR. OF SEC 26.

SCALE: 1" = 1320'

FINAL PROOF SURVEY
 UNDER

CERT. NO. 53148
 Application No. G-11234 Permit No. G-10326
 Application No. G-10366 Permit No. G-9974
 IN NAME OF

HAROLD A. BROWN

Surveyed MAY 8 19 97, by R.M. SUTTERFIELD

P.T.S. 11-7-97

Revised 5/13/93 DC
 Revised 7/23/02
 R.M.S.

RECEIVED
 WATER RESOURCES DIVISION
 SALES SECTION