

T.6N.R.35E.W.M.

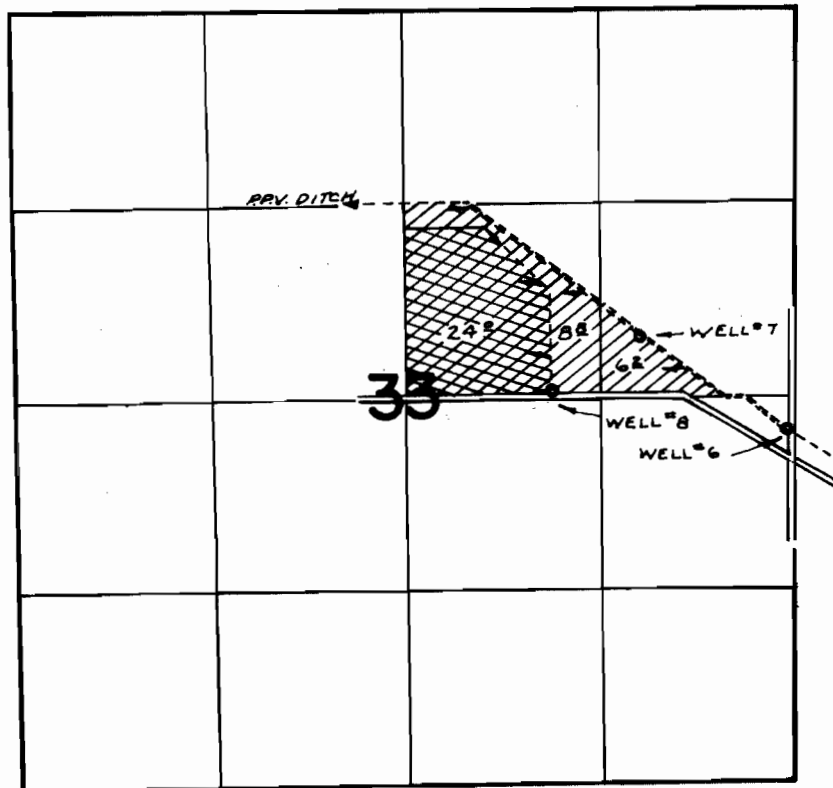

WELLS LOC: *6- 230'S & 30'W; *7- 420'N & 1040'W; *8- 30'N & 1650'W, ALL FROM E 1/4 COR. SEC 33

FINAL PROOF SURVEY UNDER

G-5861	G-4998	→	
G-5862	G-4999	→	
Application No. <u>G-5863</u>	Permit No. <u>G-5000</u>	→	

IN NAME OF

.....WILLIAM V. JACKSON.....

Surveyed APR. 11, 1973, by R. MUGGEN