

RECEIVED

NOV 01 1994

RECEIVED

MAR 14 1995

DEPT. OF REVENUE
STATE OF OREGON

*Pond is located
at "orange dot"*

SCALE 1:48000

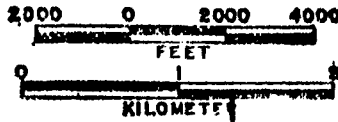

RECEIVED

JAN 12 1996

WATER RESOURCES DEPT.
SALEM, OREGON

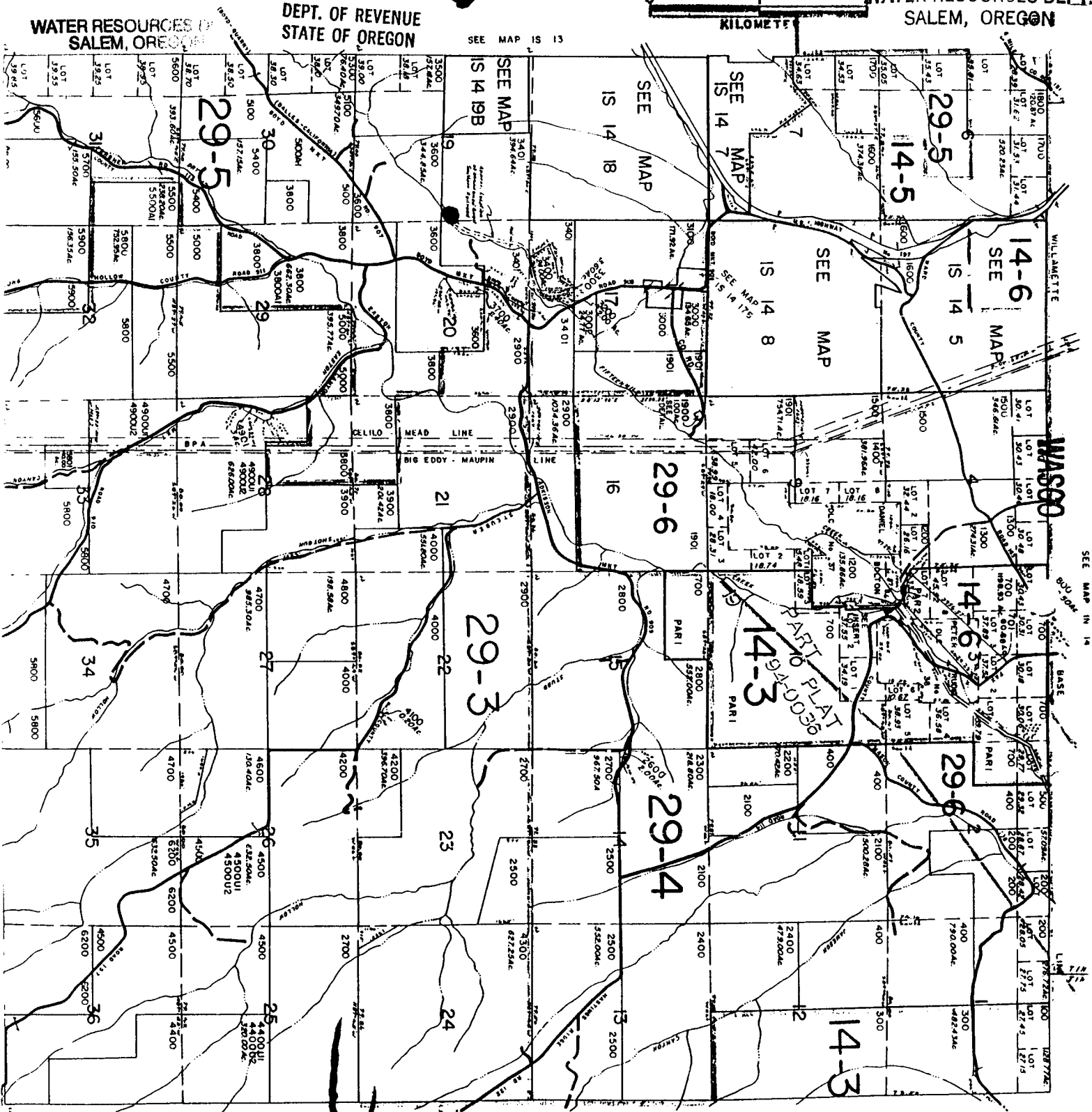

SEE MAP IS 13

SEE MAP IS 15

TO BE OPENED
FOR REVISION
BY THE COUNTY
CLERK
AND THE
WATER RESOURCES
DEPARTMENT
ON OR AFTER
THE DATE
HEREON
SET FOR THE
REVISION OF
THE PERMIT
NO. R-80834
AT THE OFFICE
OF THE COUNTY
CLERK, CLATSOP
COUNTY, OREGON.

Application No. R-80834
Permit No. R11941

SEC 3 & 10 INSERT
600
300
150
75
37.5
18.75
9.375
4.6875
2.34375
1.171875
585.9375
292.96875
146.484375
73.2421875
36.62109375
18.310546875
9.1552734375
4.57763671875
2.288818359375
1.1444091796875
572.2109375
286.10546875
143.052734375
71.5263671875
35.76318359375
17.881591796875
8.9407958984375
4.47039794921875
2.235198974609375
1.1175994873046875

14
LED NR