

T. 12 S., R. 45 E., W.M.

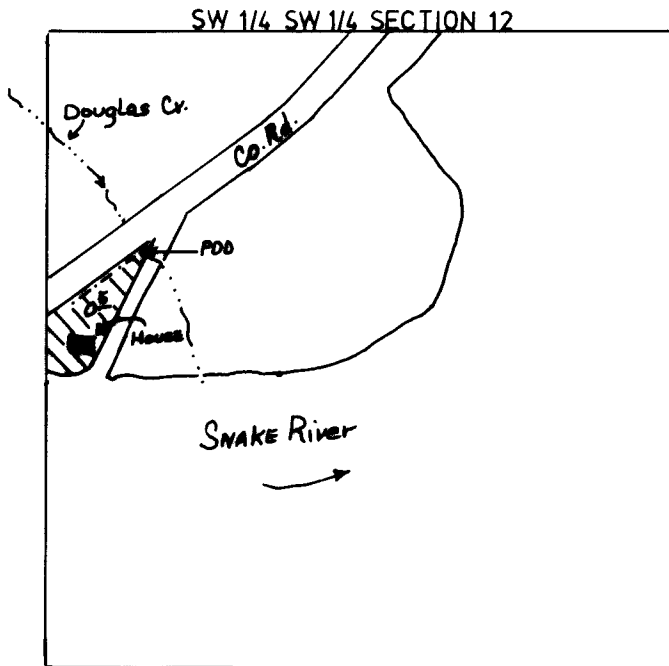

1" = 400'

POD - 860' N. & 200' E. of the SW Cor. Sec. 12.

FINAL PROOF SURVEY

UNDER

Application No. 68196 Permit No. 48966
IN NAME OF

' RAY C. GARDNER

Surveyed 6-11, 1992, by J. MILLER