

RHEA LUPER State Engineer

I, L.W. Coiner, of Cottage Grove Oregon do hereby certify that this map was made from notes taken during an actual survey made by me on March 22, 1928, and that it correctly represents the works described in the accompanying application, together with the location of streams and other ditches in the immediate vicinity

L. W. Coiner

Oregon No. 1307.
Nov. 6, 1925.

Registered Professional Engineer.

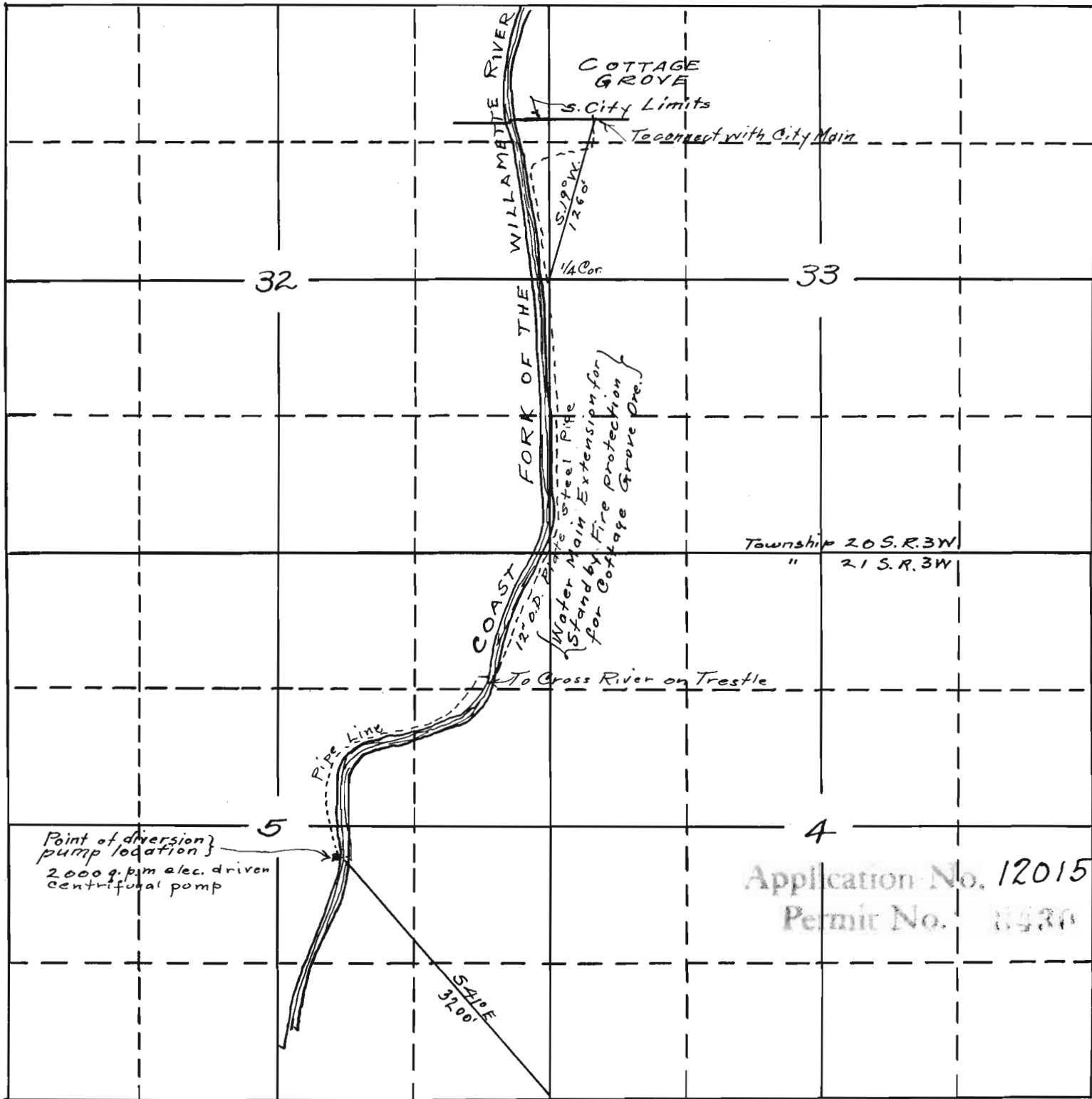

Sec 4, 5
T. 21 S. R. 3W
Sec. 32, 33
Tp. 20 S.
R. 3. W

Application No. 12015
Permit No. 11430

Scale 4" = 1 mi.