

SCALE 1" = 1320'

The preparation of this map is for the purpose of identifying water rights only, and has no intent to provide dimensions or locations of property ownership lines.

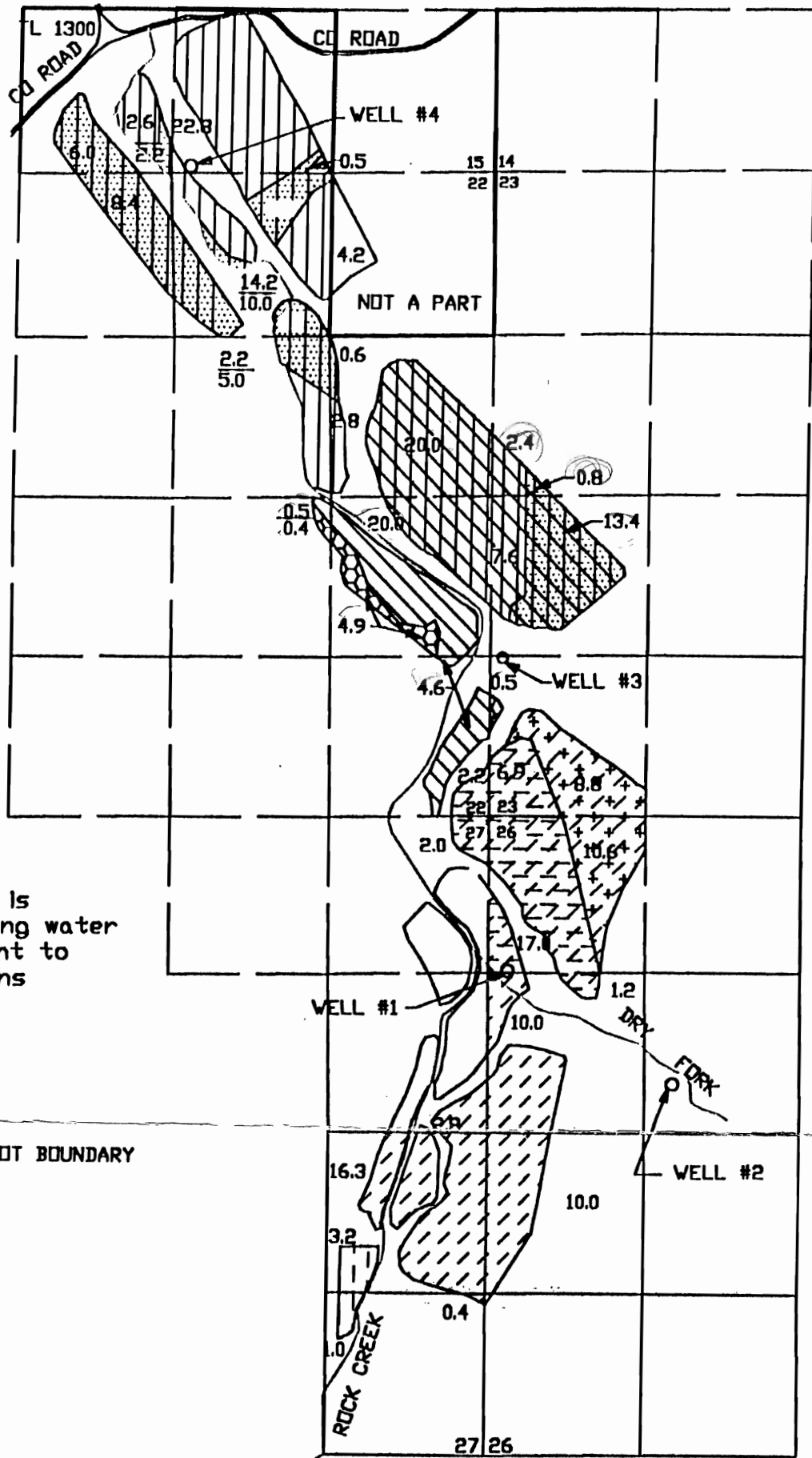

TAX LOT BOUNDARY  
 0.0 PRIMARY  
 0.0 SUPPLEMENTAL

- (1) WELL LOC. 4000' N & 170' E FROM SW CORNER, SECTION 26.
- (2) WELL LOC. 3070' N & 1560' E FROM SW CORNER, SECTION 26.
- (3) WELL LOC. 1320' N & 80' E FROM SE CORNER, SECTION 22.
- (4) WELL LOC. 50' N & 2480' W FROM SE CORNER, SECTION 15.

TRANSFER APPLICATION  
 (ADDITIONAL POINTS OF APPROPRIATION)

UNDER

| PRIMARY | SUPPLEMENTAL | Application No. | Permit No.                       |
|---------|--------------|-----------------|----------------------------------|
|         |              | (1) G-3617      | G-3400 - ADD WELL NOS. 2, 3 & 4. |
|         |              | (2) G-4029      | G-3780 - ADD WELL NOS. 1, 3 & 4. |
|         |              | (3) G-5430      | G-5356 - ADD WELL NOS. 1, 2 & 4. |
|         |              | (4) G-4185      | G-3952 - ADD WELL NOS. 1, 2 & 3. |

IN NAME OF  
 DENNIS MACNAB



RECEIVED

SEP 08 2000

WATER RESOURCES DEPT.  
 SALEM, OREGON

# T. 2 S. R. 22 E. W.M.

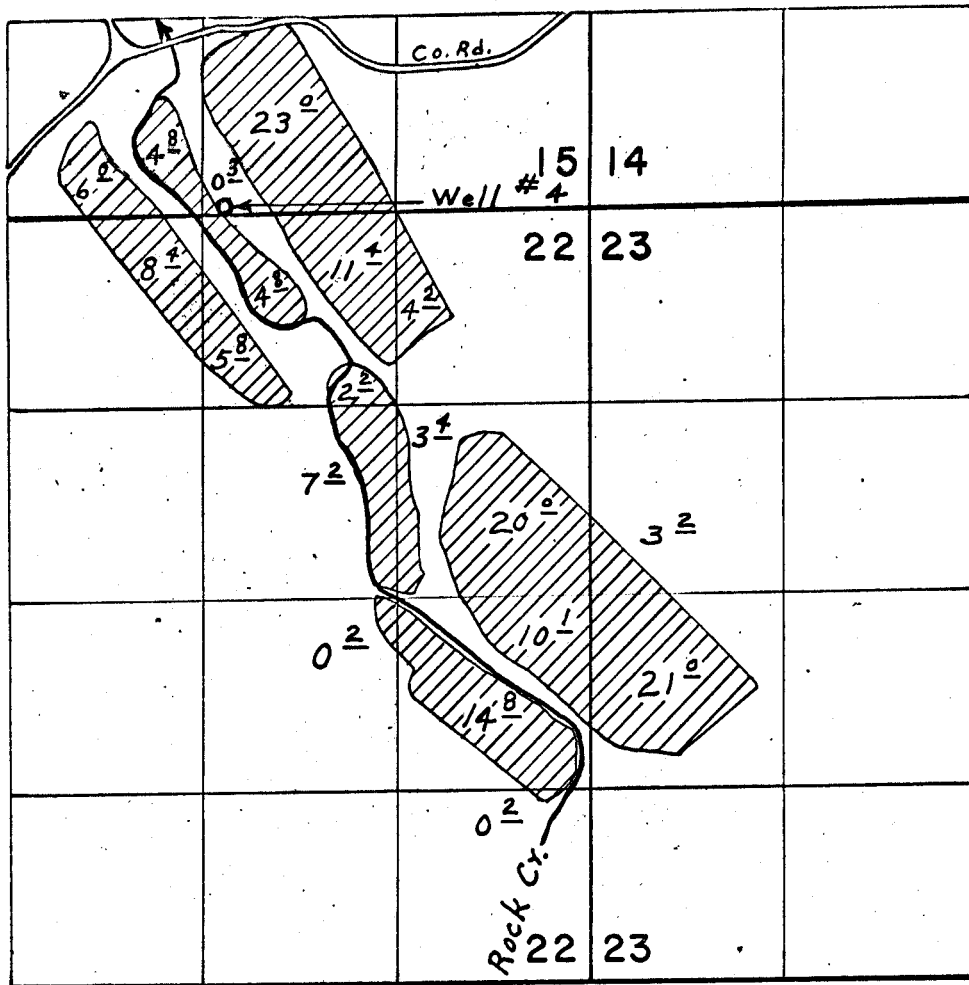

Well located 50' N. & 2480' W. from S.E. Cor. Sec. 15

## FINAL PROOF SURVEY UNDER

Application No. G-4185 Permit No. G-3952  
IN NAME OF

DALE BEAMER

Surveyed April 4, 1974, by L. E. Gould