

I. S.S., R.I.W., W.M.

RECEIVED

AUG 4 1992

WATER RESOURCES DEPT  
SALEM, OREGON

RECEIVED

SEP 09 1998

WATER RESOURCES DEPT.  
SALEM, OREGON

SCALE: 1" = 400'

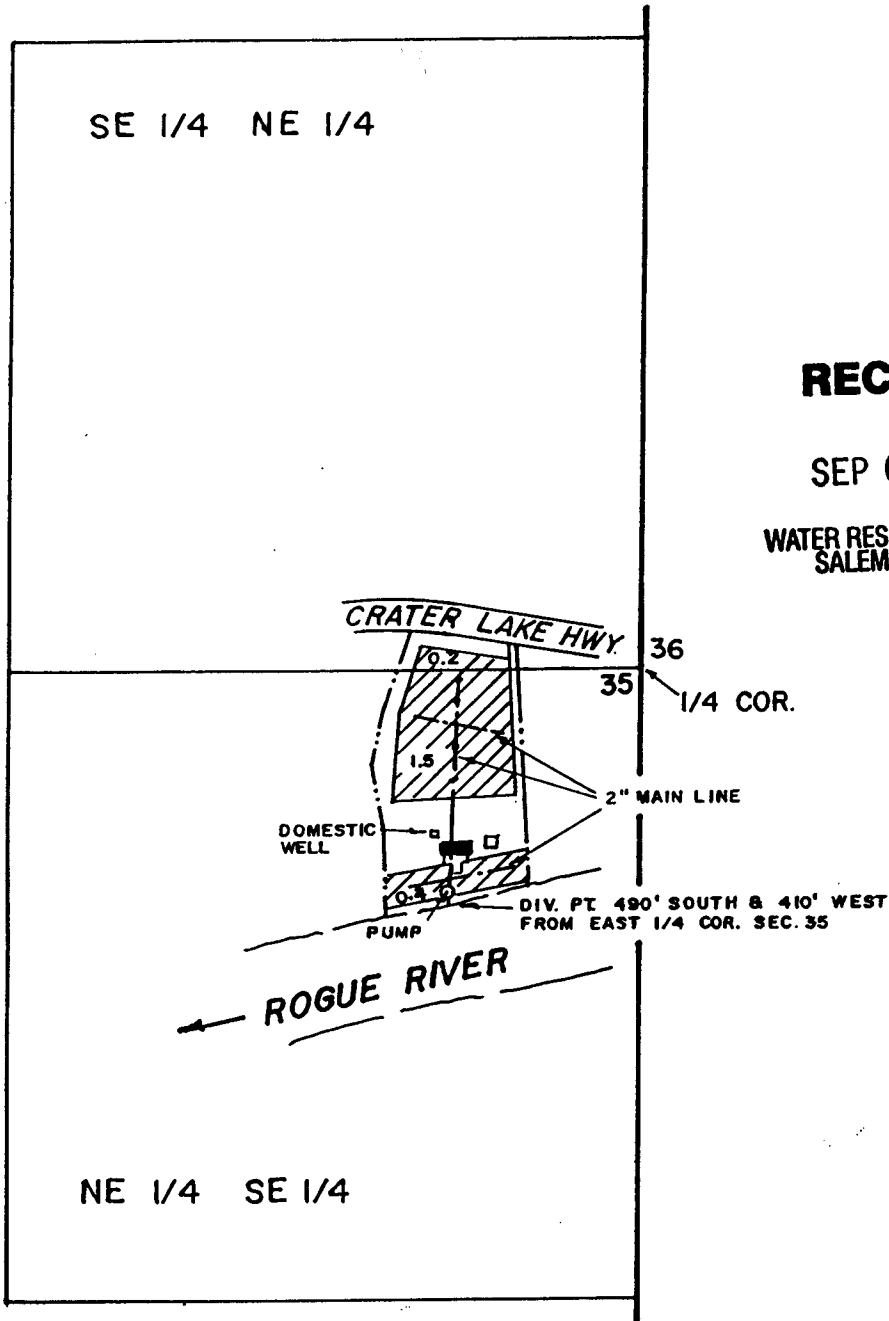

**FINAL PROOF MAP**

APPLICATION NO 69698 PERMIT NO. 50424

**NOTE THIS MAP HAS BEEN PREPARED FOR WATER RIGHT PURPOSE ONLY, NOT FOR PROPERTY BOUNDARY LOCATIONS**

IN THE NAME OF

GLENN J. BARTON & JERILYNN BARTON

MAP PREPARED JULY 29, 1992 BY GARY D. KAISER

