

FINAL PROOF SURVEY FOR APPLICATION S-73606 AND PERMIT 53042

T 35 S, R 7 W, SECTION 6, WM

RECEIVED

JOSEPHINE COUNTY, OREGON

MAY 10 2000

April 9, 2000

WATER RESOURCES DEPT.
SALEM, OREGON



1"=400'

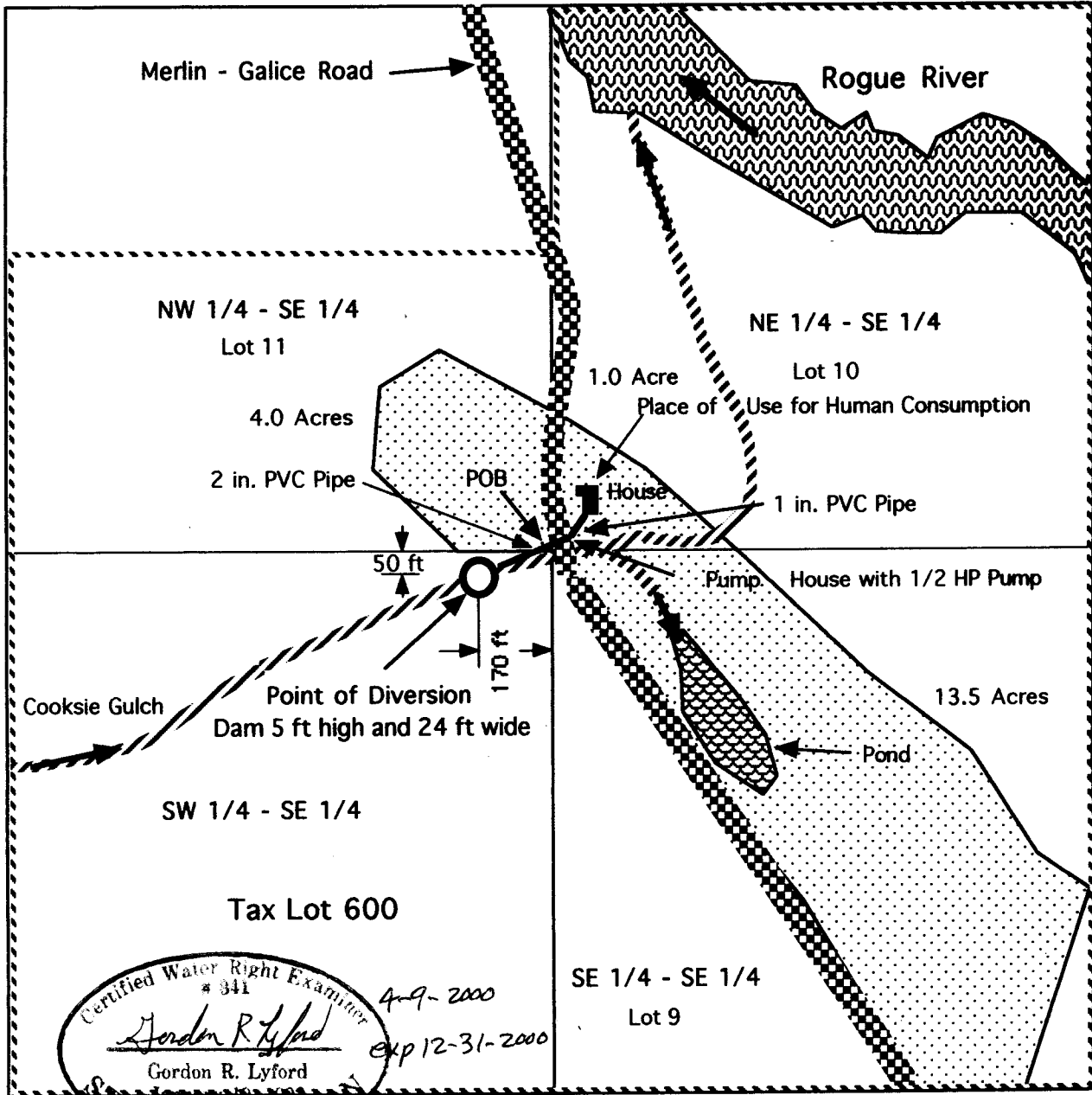

Certified Water Right Examiner
341
Gordon R. Lyford
Gordon R. Lyford
January 19, 1998
STATE OF OREGON
4-9-2000
exp 12-31-2000

 Irrigation Water Right Permit S-4918, Certificate 5363, Priority January 22, 1921
1.0 acre NE1/4SE1/4, 4.0 acres NW1/4SE1/4, and 13.5 acres SE1/4SE1/4.

 Perimeter of Tax Lot 600

This map was prepared for the purposes of identifying the location of water rights only and is not intended to provide legal dimensions or the location of property ownership lines.