

T. 4N., R. 28E., W. M.

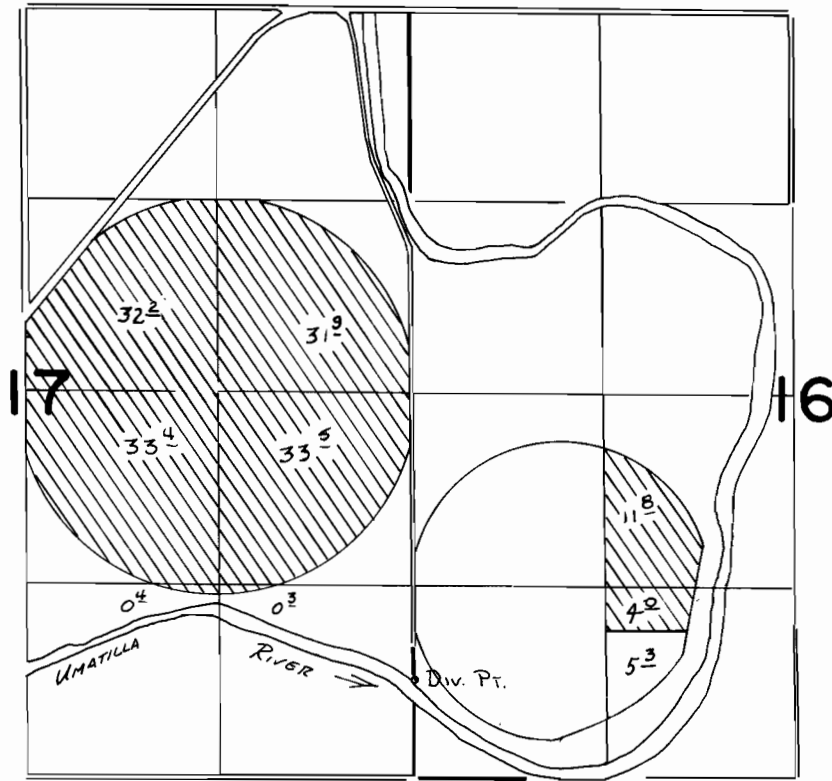

Div. Pt. LOCATED 660' N. & 10' E. FROM SW COR. SEC 16

SCALE 1" = 1320'

FINAL PROOF SURVEY
UNDER

Application No. **59253**. Permit No. **44614**....
IN NAME OF

.....**NORMA QUICK**.....

Surveyed *May 9*... 19*84*, by *V.L. Church*.....