

RECEIVED

JAN 12 2000

WATER RESOURCES DEPT.
SALEM, OREGON

**CLAIM OF BENEFICIAL USE
SURVEY DECEMBER 31, 1999
BY DUANE KIRBY
FOR RONALD L. OWINGS**

T22. R8W. WM

SCALE 1" = 1320'

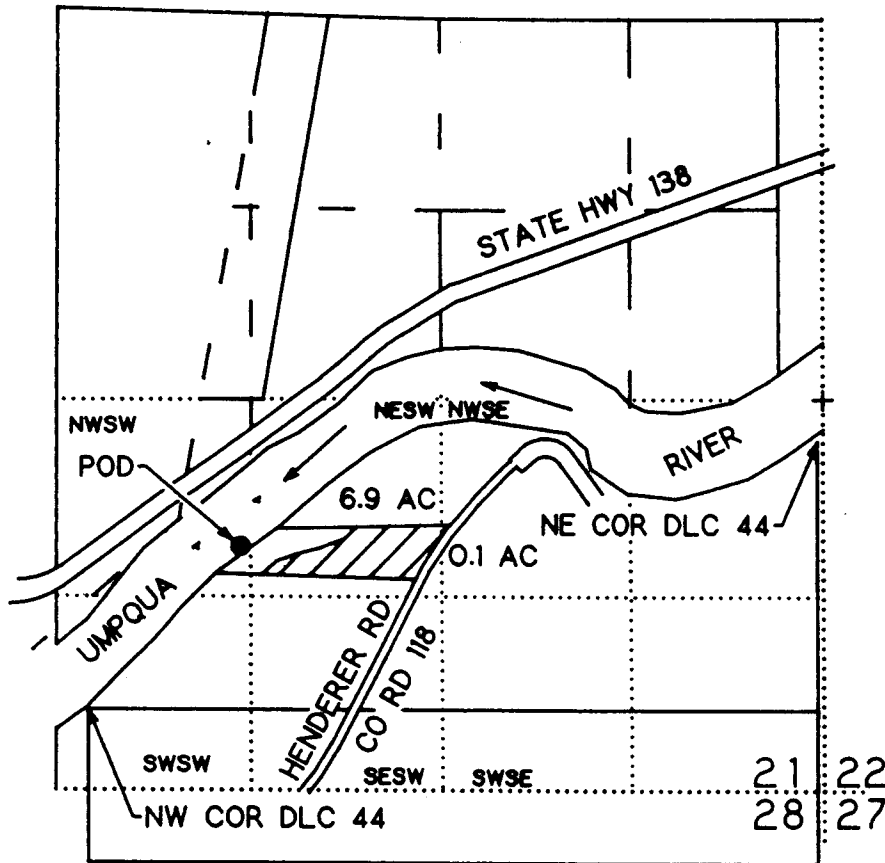

POD IS 1090 FT N AND 1040 FT E FROM NW CORNER
WM HATHAWAY DLC NO. 44

THE PURPOSE OF THIS MAP IS TO IDENTIFY THE
LOCATION OF THE WATER RIGHT. IT IS NOT
INTENDED TO PROVIDE LEGAL DIMENSIONS OR
THE LOCATION OF PROPERTY OWNERSHIP LINES.

