

T.13 S., R. 32 E., W.M.

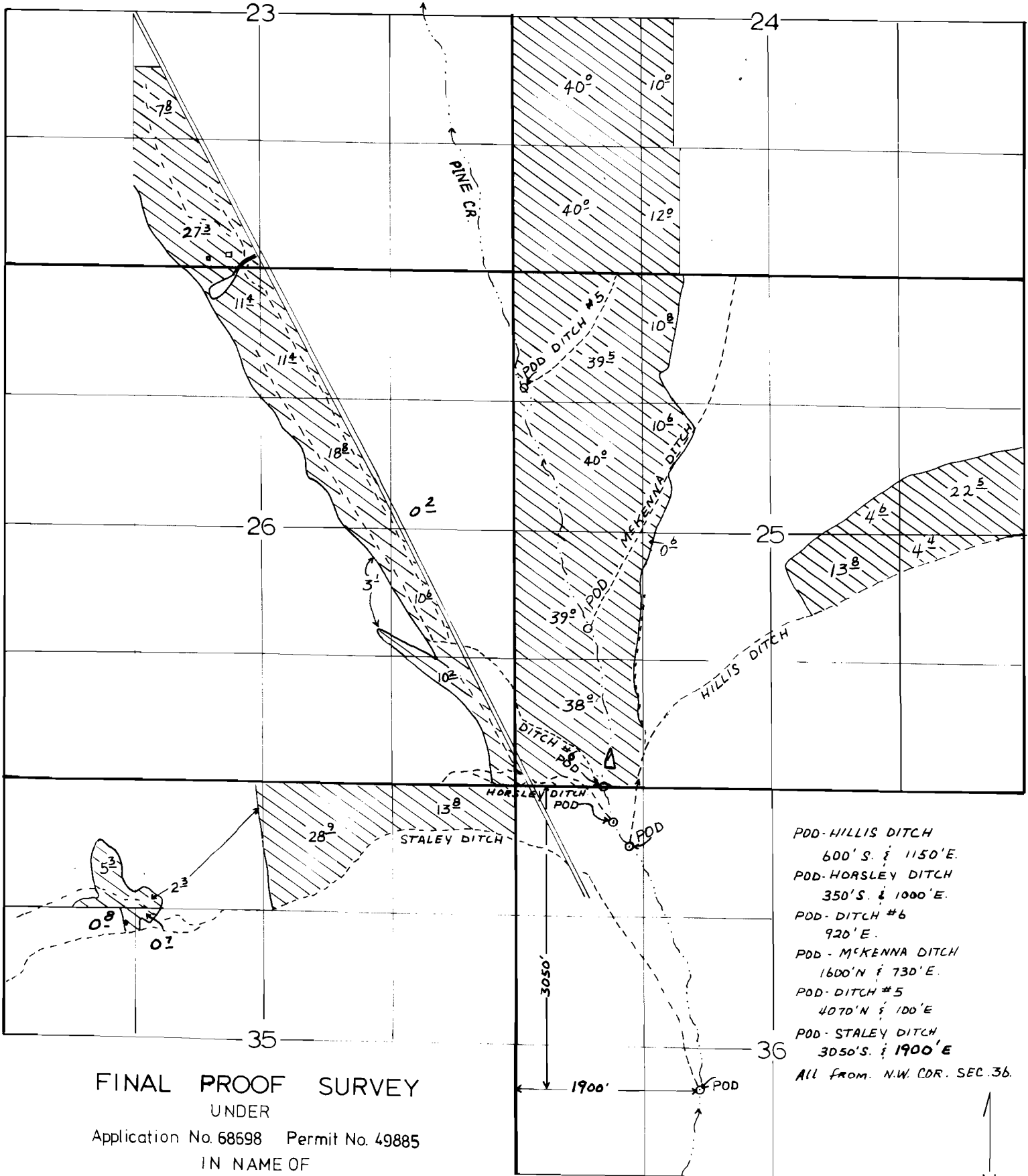

PDD-HILLIS DITCH
 600' S. & 1150' E.
 PDD-HORSLEY DITCH
 350' S. & 1000' E.
 PDD-DITCH #6
 920' E.
 PDD-MCKENNA DITCH
 1600' N & 730' E.
 PDD-DITCH #5
 4070' N & 100' E
 PDD-STALEY DITCH
 3050' S. & 1900' E
 All from N.W. COR. SEC. 36.

FINAL PROOF SURVEY
 UNDER
 Application No. 68698 Permit No. 49885
 IN NAME OF
CLYDE HOLLIDAY AND SONS

Surveyed 4-12-1994, by J. MILLER

Revised 7-28-03 *JM*
 8-19-94 J.M. 41023-279-57L, 56R

1" = 1320'

