

T. I. S. R. I. E. W. M.

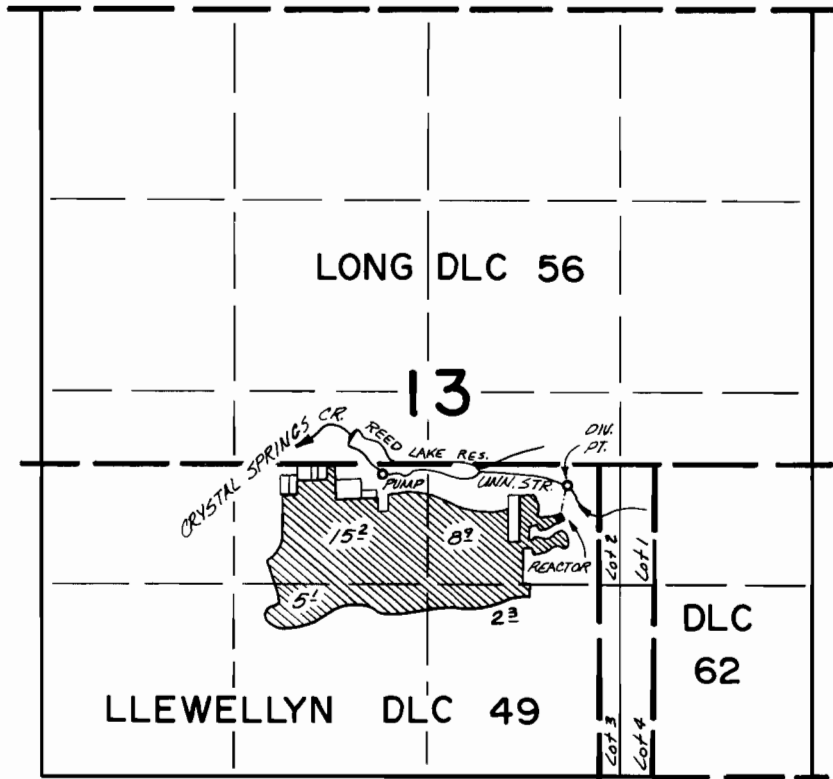

UNIV. STR. DIV. PT. 140'S. & 210'W., RES. DIV. PT. 200'N. & 1480'W.  
BOTH FROM NE. COR. LLEWELLYN DLC 49

**FINAL PROOF SURVEY**

UNDER

44025

32907

41222

30846

Application No. R 41866 Permit No. R 4658

IN NAME OF

REED INSTITUTE

Surveyed JULY 8 1975, by R.G. MUCKEN