

G-10703

T. 26 S., R. 18 E., W.M.

68204
75867
80581

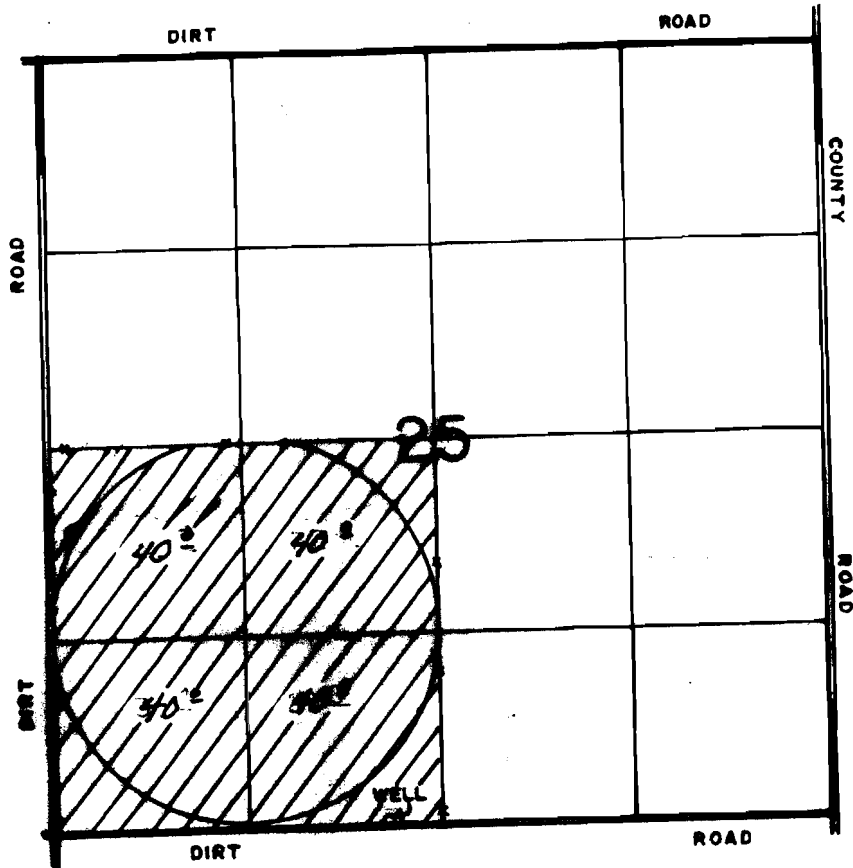

WELL LOC: 30° N & 3000' E. FROM SE COR. OF SEC 25.

SCALE 1" = 1320'

FINAL PROOF SURVEY

UNDER

Application No. G-11201 Permit No. G-10703
IN NAME OF

RICHARD C. SMITH

Surveyed APRIL 7, 1992, by B. W. BISHOP