

# T6S. R3W. WM.

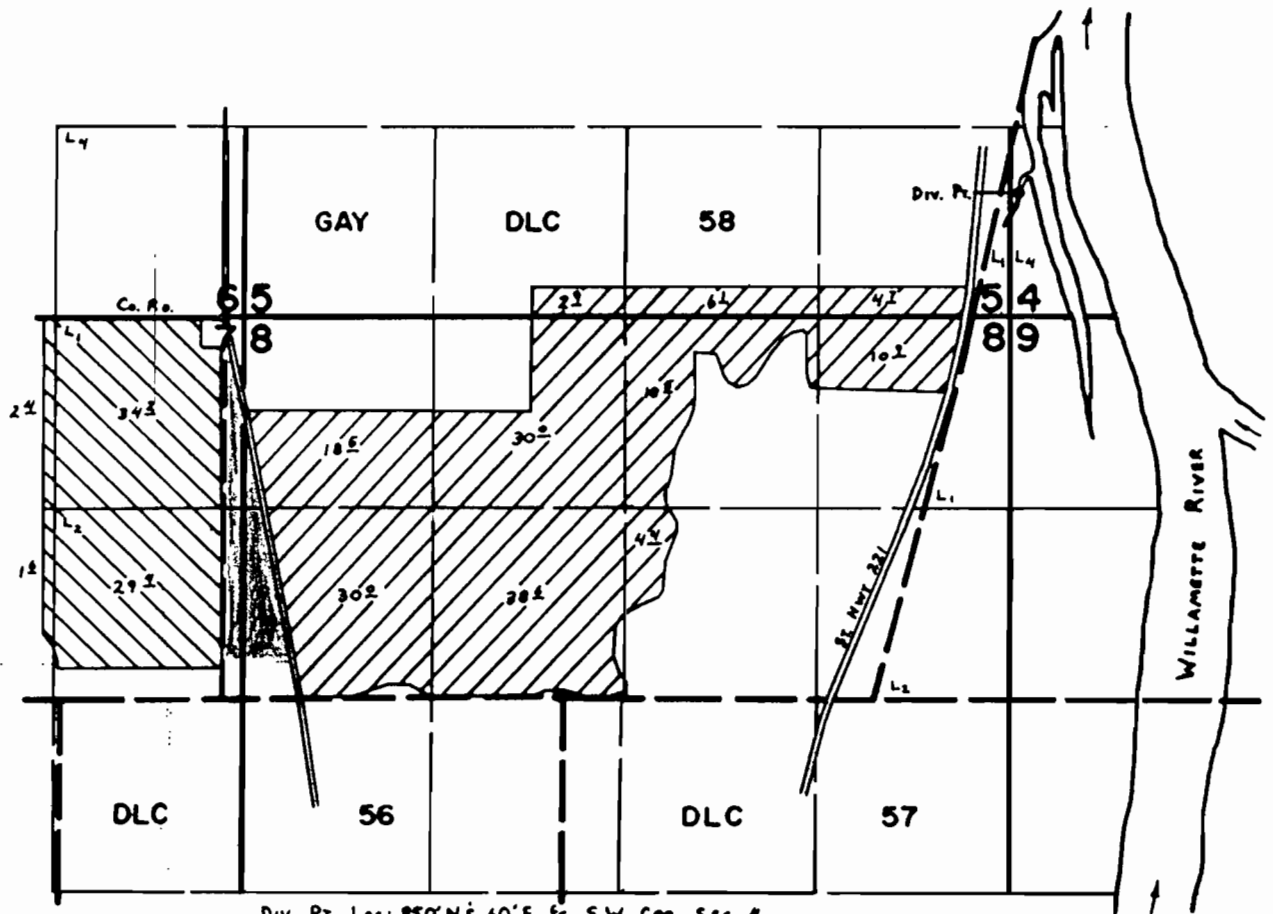

Div. Pt. Loc: 85° N, 60° E. fr. S.W. Cor. Sec. 9.  
 [Hatched Box] - PRIMARY IRR - APP. 47069; SUPPLEMENTAL IRR - APP. 65916.  
 [Cross-hatched Box] - PRIMARY IRR - APP. 47069

## FINAL PROOF SURVEY UNDER

47069                      35203  
 Application No. 55916.. Permit No. 42189.....  
 IN NAME OF

.....ANTON P. PIETROK.....

Surveyed ..May..15.. 19..79.. by ..C.L..HUGHES....