

8760

No. R 539

MAP

and

Application No 8760

Permit No 5730

ACCOMPANYING APPLICATION  
OF

J. L. Sitz,  
Drewsey, Ore.

STATE ENGINEER  
RECEIVED

DEC 18 1922

SALEM, OREGON

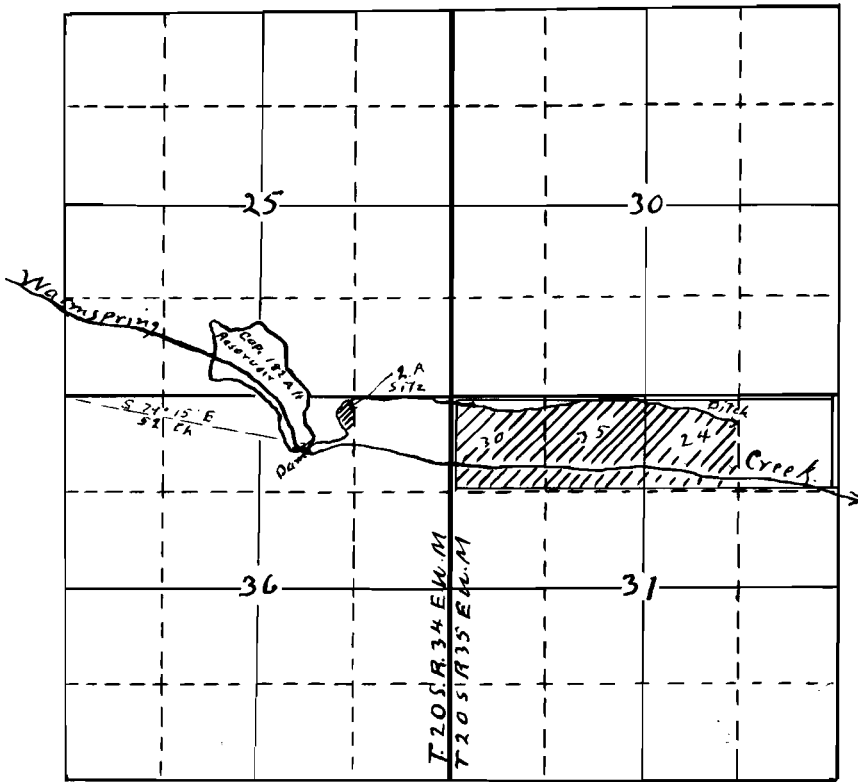

I, J. Edwin Johnson, of Vale, Oregon, hereby certify that this map was made from notes taken during an actual survey, made by me Sept 15, 1922, and that it correctly represents the works described in the accompanying application, together with the location of streams and other ditches in the immediate vicinity, and has written thereon the area in each smallest legal sub-division which it is proposed to irrigate

J. Edwin Johnson  
Surveyor