

T. 41 S., R. 35 E., W.M.

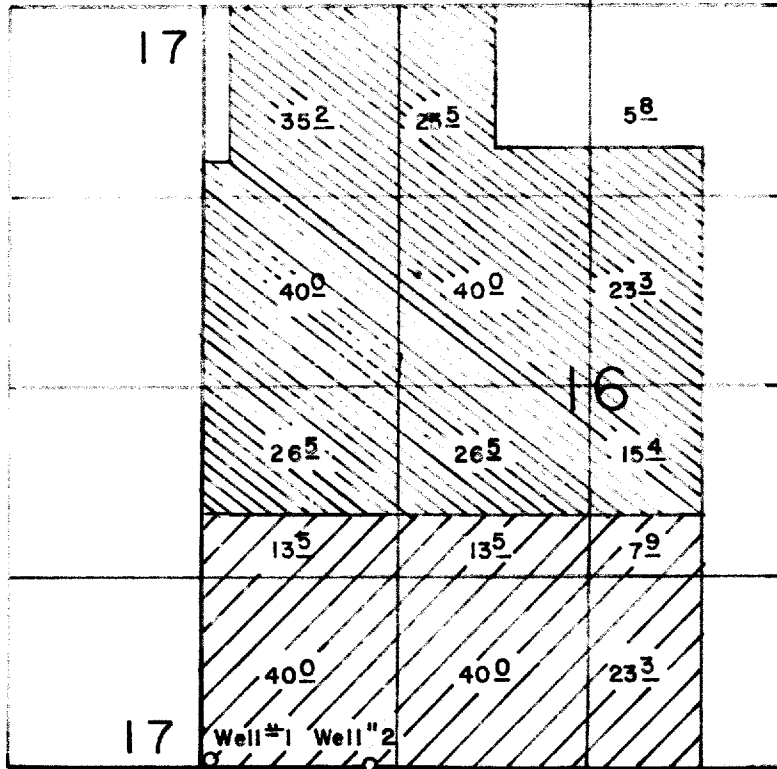

Well #1 - 50 Feet North and 50 Feet East; Well #2 - 10 Feet North and 1150 Feet East; both from the SW Corner Section 16.



G-7638



T-3771

FINAL PROOF SURVEY UNDER

Transfer No. T-3771

Application No. ~~G-8199~~ Permit No. G-7638.....

IN NAME OF

Leo R. Barclay

Surveyed July 16, 1988, by V. Church.....

PTS Redraft *[Signature]*