

T-5886

T.2 N., R.10E., W.M.

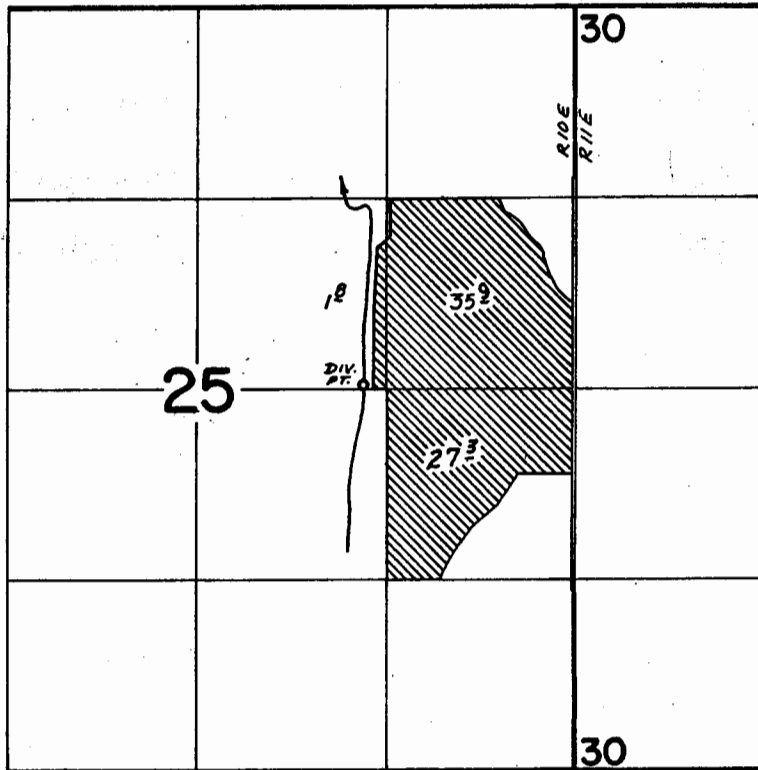

DIV. PT. LOC: 30' N $\frac{1}{2}$  160' W FROM SE COR. SW $\frac{1}{4}$  NE $\frac{1}{4}$  SEC. 25

**FINAL PROOF SURVEY**  
UNDER

Transfer No. T-65  
Application No. .... Permit No. ....  
IN NAME OF

**TALLMAN ORCHARDS**

Surveyed April 15, 1975, by D. Norby

# T. IN., R. 10 & 11 E., W. M.

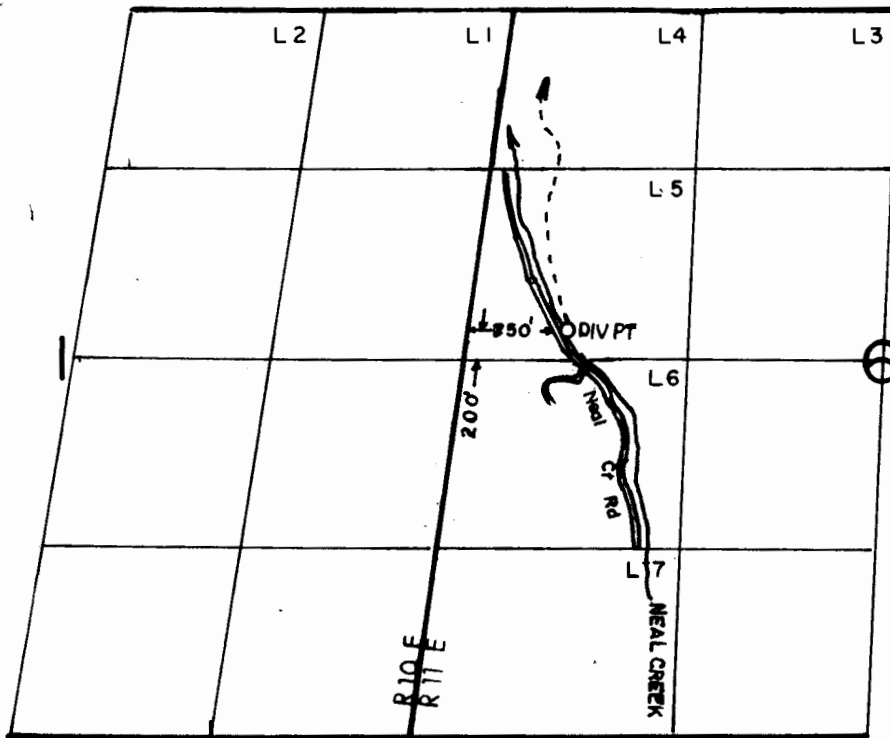

SCALE: 1" = 1320'

## FINAL PROOF SURVEY UNDER

TRANSFER NO. 5886

Application No. .... Permit No. ....  
IN NAME OF

.....TALLMAN.....ORCHARDS.....INC.....

Surveyed JULY..14.. 1988., by Z. F. SALEH.....