

RECEIVED

JUN 30 1997

T.4S., R.1W., W.M.

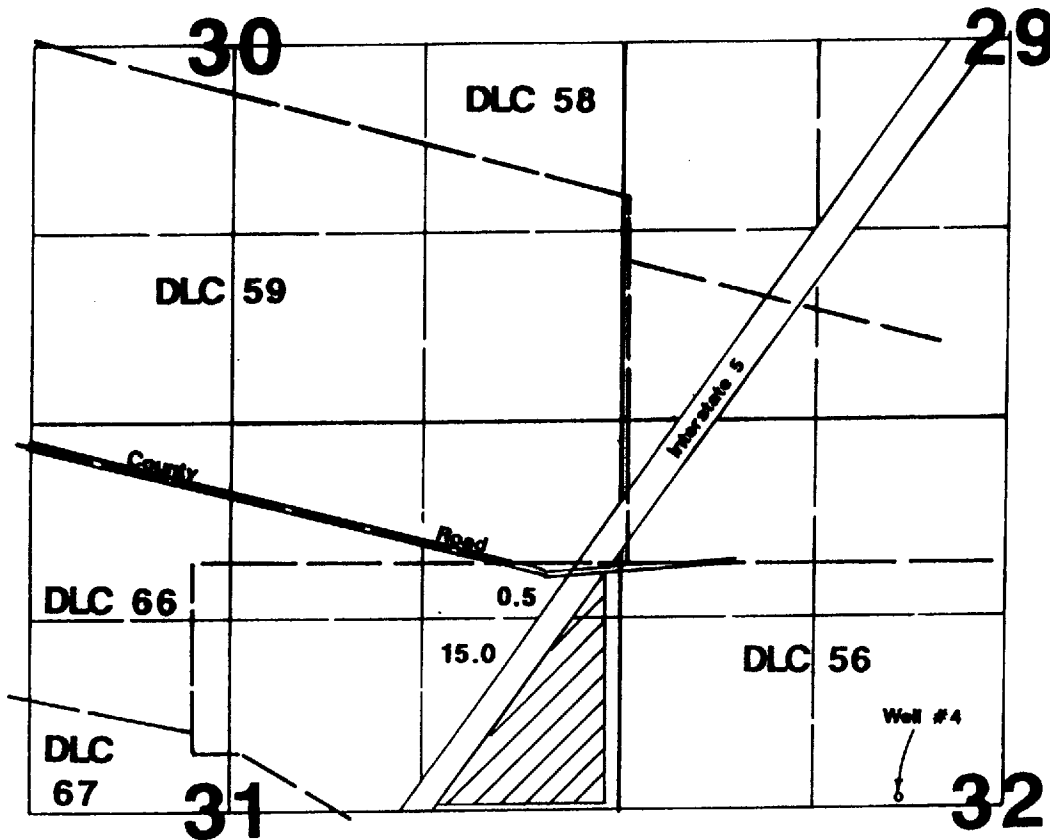

1" = 1320'

Area Irrigated



Well #4 located 60'N & 1950'E from W¼ corner of Section 32.

Final Proof Survey

Application: G-13350 Permit #: G-12099

In Name Of

Jesse C. Owre

Surveyed on June 10, 1997 by JM Schuette

THIS MAP WAS PREPARED FOR THE PURPOSE OF IDENTIFYING THE LOCATION OF A WATER RIGHT ONLY AND IS NOT INTENDED TO PROVIDE LEGAL DIMENSIONS OR LOCATION OF PROPERTY OWNERSHIP LINES.

