

T263
~~T.37S.,R.6W.,W.M.~~

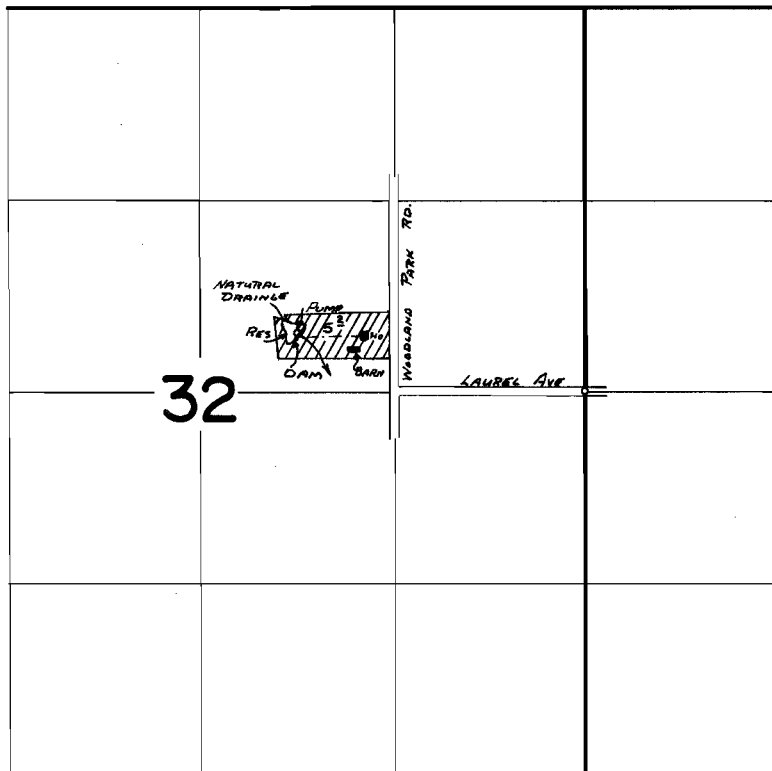

DAM LOC: 400' N AND 1980' W FROM E 1/4 COR. SEC. 32

FINAL PROOF SURVEY
UNDER

Application No. R-47948 47949 Permit No. R-5810 35949
IN NAME OF

RAY STALCUP

Surveyed OCT. 9 1974, by L. T. RAY