

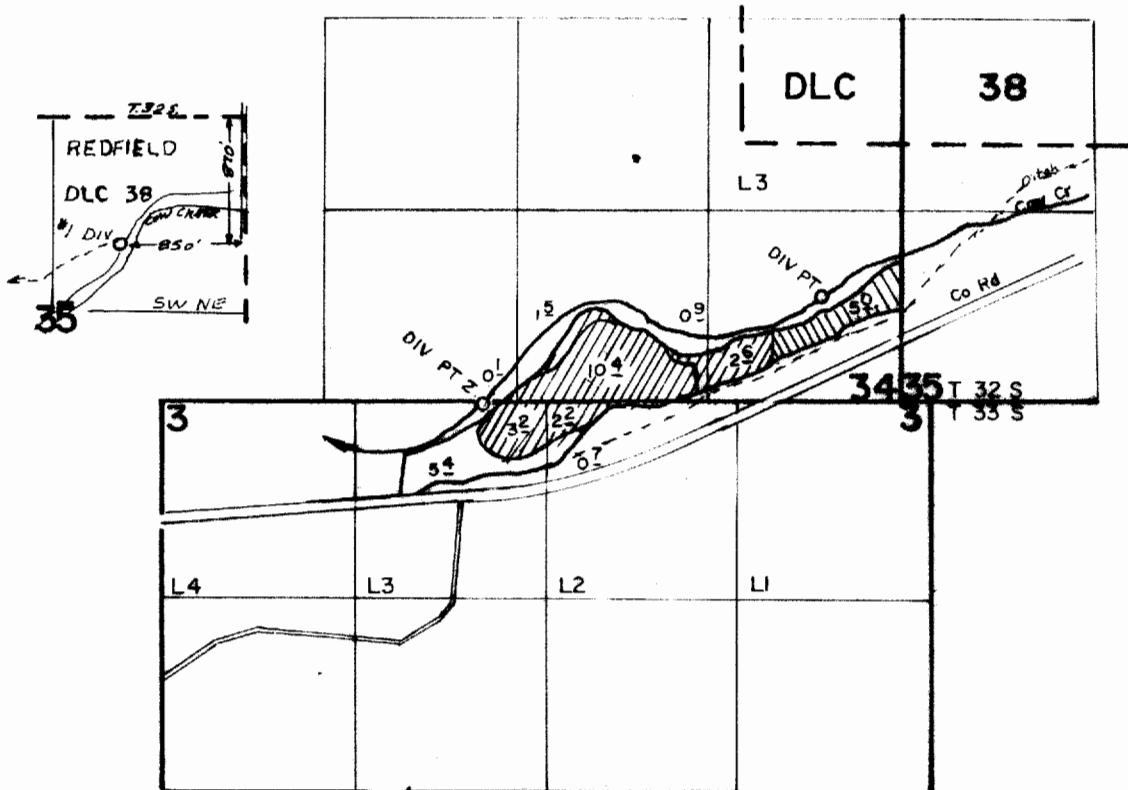

T. 32 & 33 S., R. 6 W., W.M.

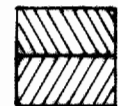

Div Pts Loc 700' N & 525' W From SE Cor Sec 34, No 2 - 250' W From S 1/4 Cor. Sec 34

 Transfer 5353
 Transfer 5352

FINAL PROOF SURVEY

UNDER

TRANSFER NO. 5352
 5353

Application No. Permit No.
 IN NAME OF

JOHN O SETHER

Surveyed AUG. 27. 1984., by LYNN CASHION...