

T. 32 & 33 S., R. 6 W., W.M.

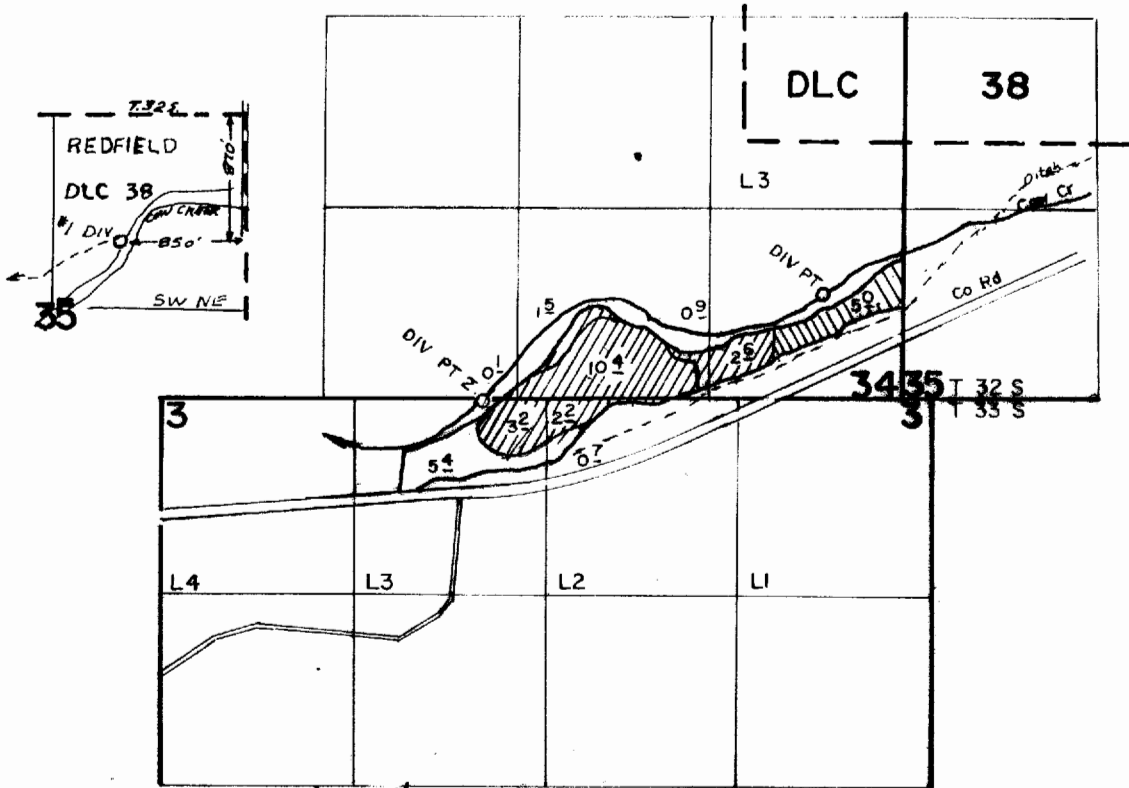

Div Pts Loc 700' N & 625' W From SE Cor Sec 34, No 2 - 250' W From S 1/4 Cor. Sec 34

 Transfer 5353
 Transfer 5352

FINAL PROOF SURVEY

UNDER

TRANSFER NO. 5352
5353

Application No. Permit No.
IN NAME OF

..... JOHN O. SETHER

Surveyed AUG...27... 1984., by LYNN CASHION...