

T. 5N. R. 29E. W.M.

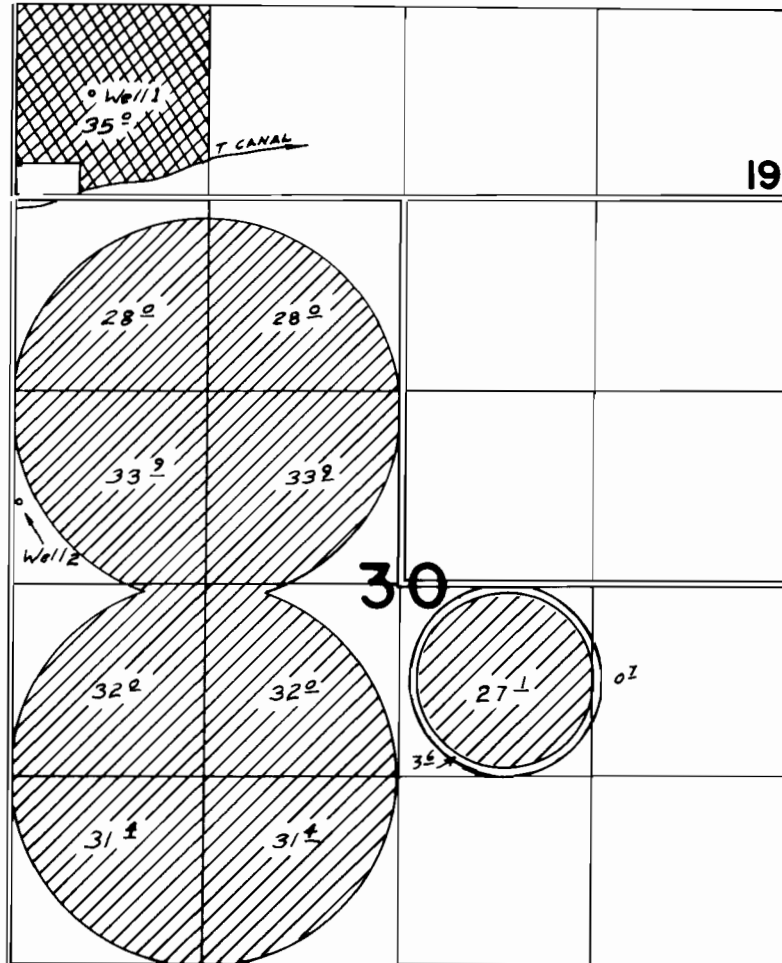

Well 2 Loc.: 2080 ft. S. & 40 ft. E. from NW Cor. Sec. 30

Well 1 Loc.: 700 ft. N. & 510 ft. E. from SW Cor. Sec. 19



PRIMARY



SUPP'L

FINAL PROOF SURVEY

UNDER

Application No. G-6076.. Permit No. G-5763
IN NAME OF

W. Bryan Wolfe et al

Surveyed 10-26 1972, by R. BARWIN
7-24 76 L. H. NUNN