

RECEIVED

SEP 29 1997

WATER RESOURCES DEPT.  
SALEM, OREGON

THIS MAP IS FOR THE PURPOSE OF OBTAINING A  
WATER RIGHT AND IS NOT INTENDED TO PROVIDE  
LEGAL DIMENSIONS FOR LOCATIONS OF PROPERTY  
BOUNDARIES.

RECEIVED

APR 08 2004

WATER RESOURCES DEPT  
SALEM, OREGON

FINAL PROOF SURVEY

SW 1/4, NE 1/4 & NW 1/4, SE 1/4  
SECTION 11, T.14 S., R.4 W., W.M.

LINN COUNTY, OREGON  
APPLICATION FILE NO. R-75044

PERMIT NO. R-11637  
IN THE NAME OF  
PAUL AND MARY ZEHM

APRIL 19, 1996

SW 1/4, NE 1/4

SE 1/4, NE 1/4

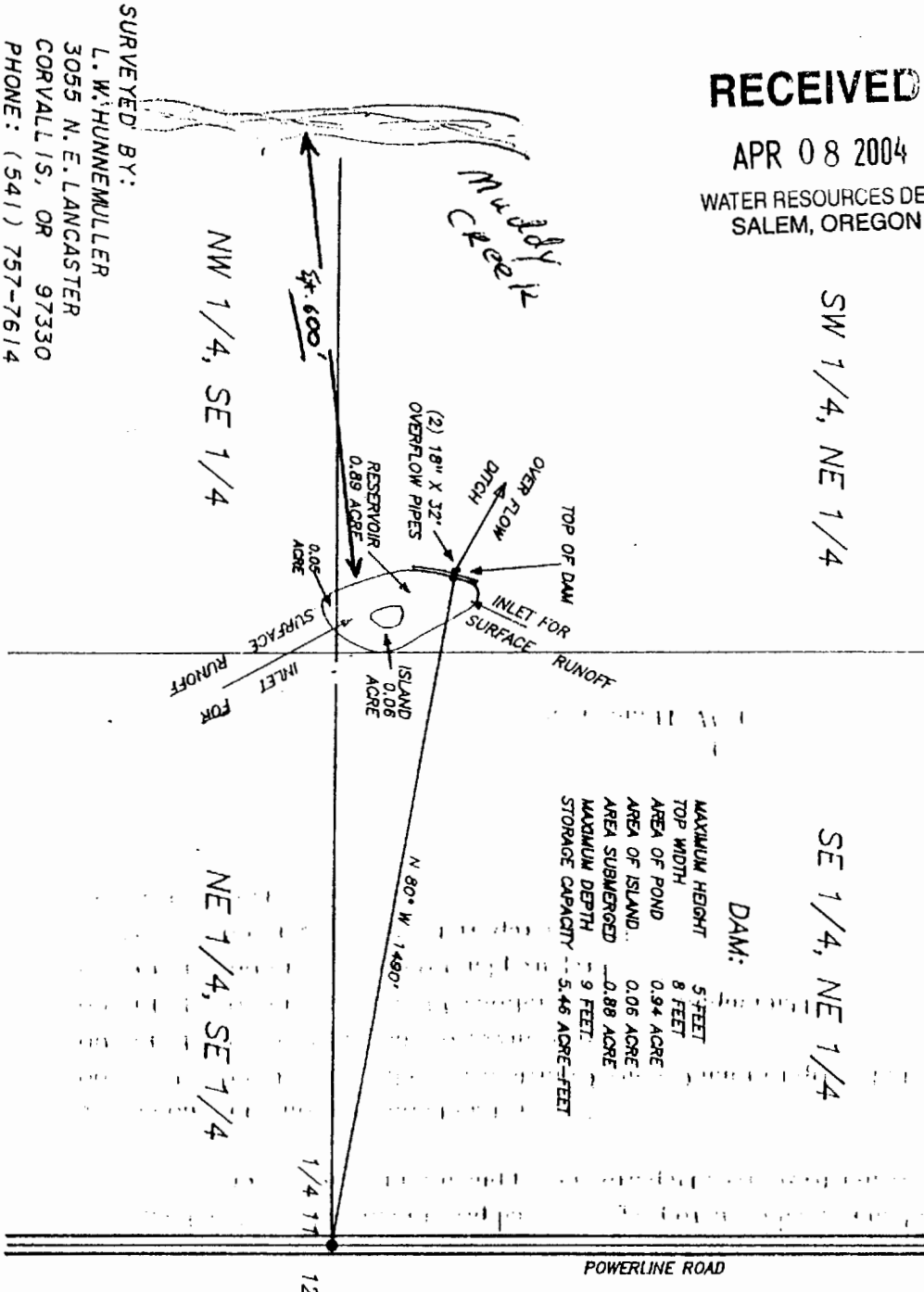

SURVEYED BY:  
L. W. HUNNEMULLER  
3055 N. E. LANCASTER  
CORVALLIS, OR 97330  
PHONE: (541) 757-7614

POWERLINE ROAD

Application No. R 83559  
Permit No. R12391

LEGEND

PROJECTED SECTION LINE  
PROJECTED 40 LINE  
FOUND 3 1/4" AL CAP  
IN MONUMENT BOX  
M.D. LINN COUNTY SURVEYOR  
745 R4W 1/4 11 12  
LS 431 1994  
BASIS OF BEARING "NORTH"  
POWER LINE RD.  
SCALE 1" INCH = 400 FEET

