

MAP ACCOMPANYING APPLICATION
FOR PERMIT TO APPROPRIATE WATER.

CERTIFICATE OF
REGISTERED PROFESSIONAL ENGINEER.

I, Jesse C. Ayers, of Eugene, Oregon, do hereby certify that this map was made from notes taken during an actual survey made by me on May 15, 1925, and that it correctly represents the works described in the accompanying application together with the location of streams and other ditches in the immediate vicinity.

Jesse C. Ayers.
Registered Professional Engineer.
Oregon No. 1035.
Jan. 1, 1920.
Date of Registration

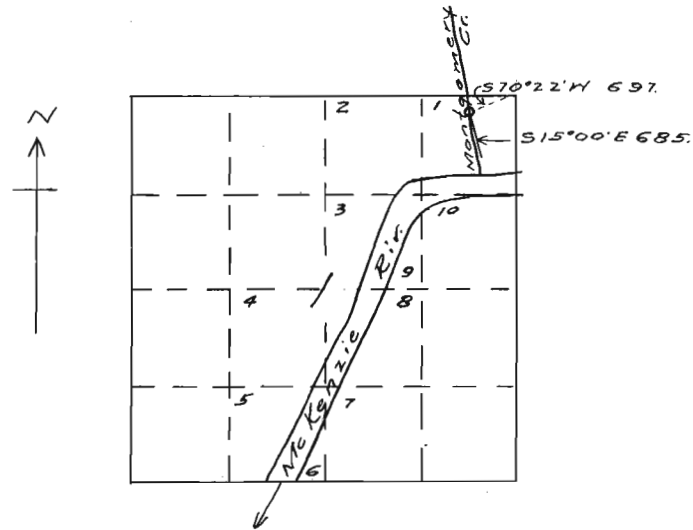

SEC. 1, T15S, R1E, W. 1M.

Scale: 2 in = 1 mi.

Application No. 12126
Permit No. 8533