

SEC. 15 T.25S. R. 6W W.M.
DOUGLAS COUNTY

WILCOX FAMILY FARM LLC WETLAND ENHANCEMENT
SEE MAP 25 6 10

REVISED ON
4-1-97



RECEIVED

JUN 01 2004

WATER RESOURCES DEPT
SALEM, OREGON

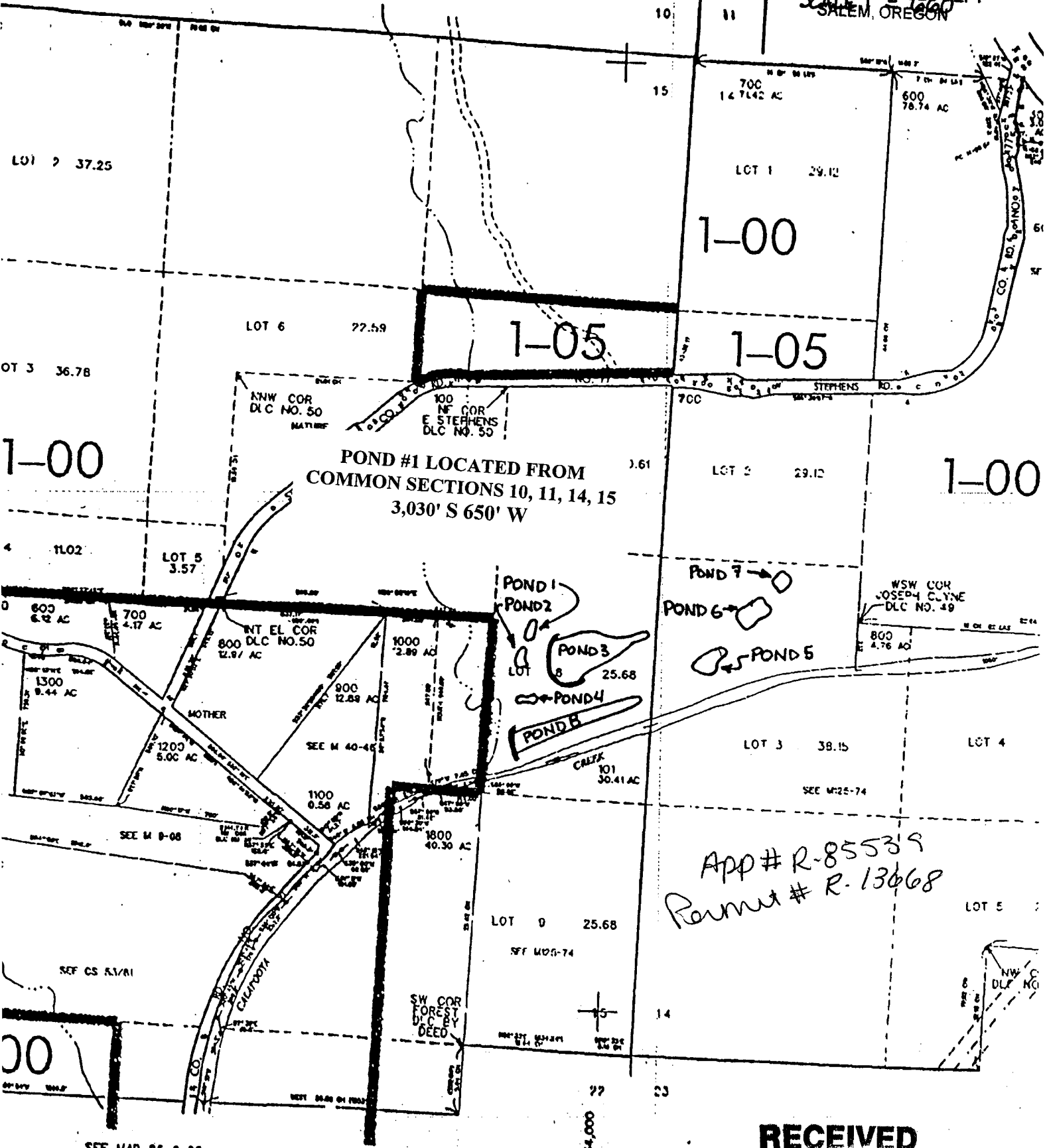

App # R-85539
Permit # R-13668

RECEIVED

APR 07 2003