

Township 6 N

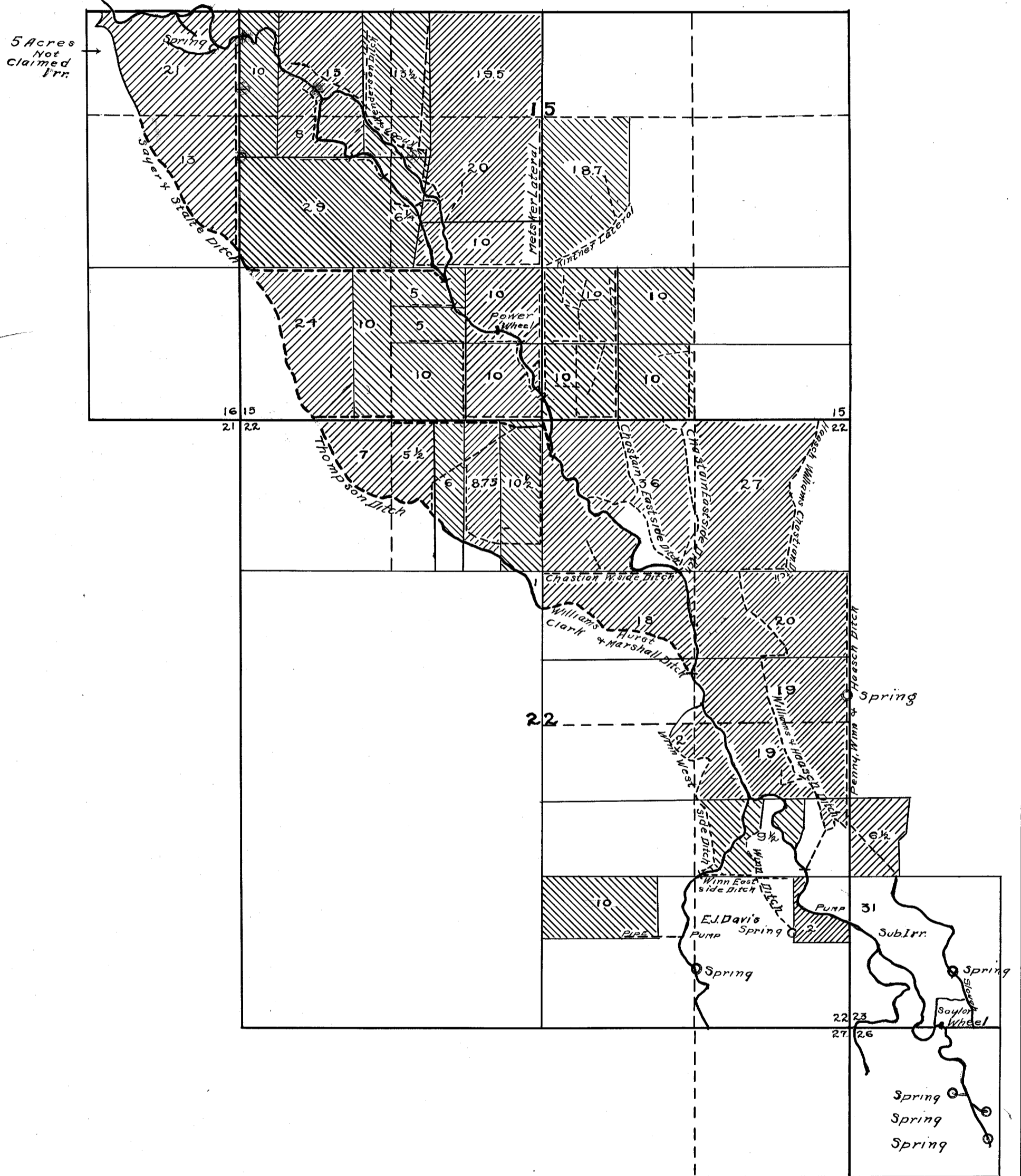



Range 35 E



Adjudication Survey
of
West Prong of Little Walla Walla River
March 10-30 1915

Scale 1" = 880 ft.

Legend

-  Irrigated Lands
-  Ditches
-  Streams
-  Springs

T6N, R35E, WM
Section 22
Umatilla County



1 inch = 400 feet

LEGEND

○ **Authorized POA**
Headgate in West Prong Little
Walla Walla River located
1290 feet S and 1410 feet W
from NE Corner of Section 22

△ **Weir**
Weir controls and measures
flow about 20 feet from
Authorized POD

□ **Pump**
Centrifugal pump station lifts
water into pressurized
mainline for conveyance and
distribution throughout

--- **Conveyance**
Open ditch from POD to weir.
Buried PVC pipelines from weir
to pump to sprinklers. Water
applied with Nelson 20W
impact sprinklers.

▨ **Place of Use**
19.01 acres in NE/4, NE/4 of
Section 22

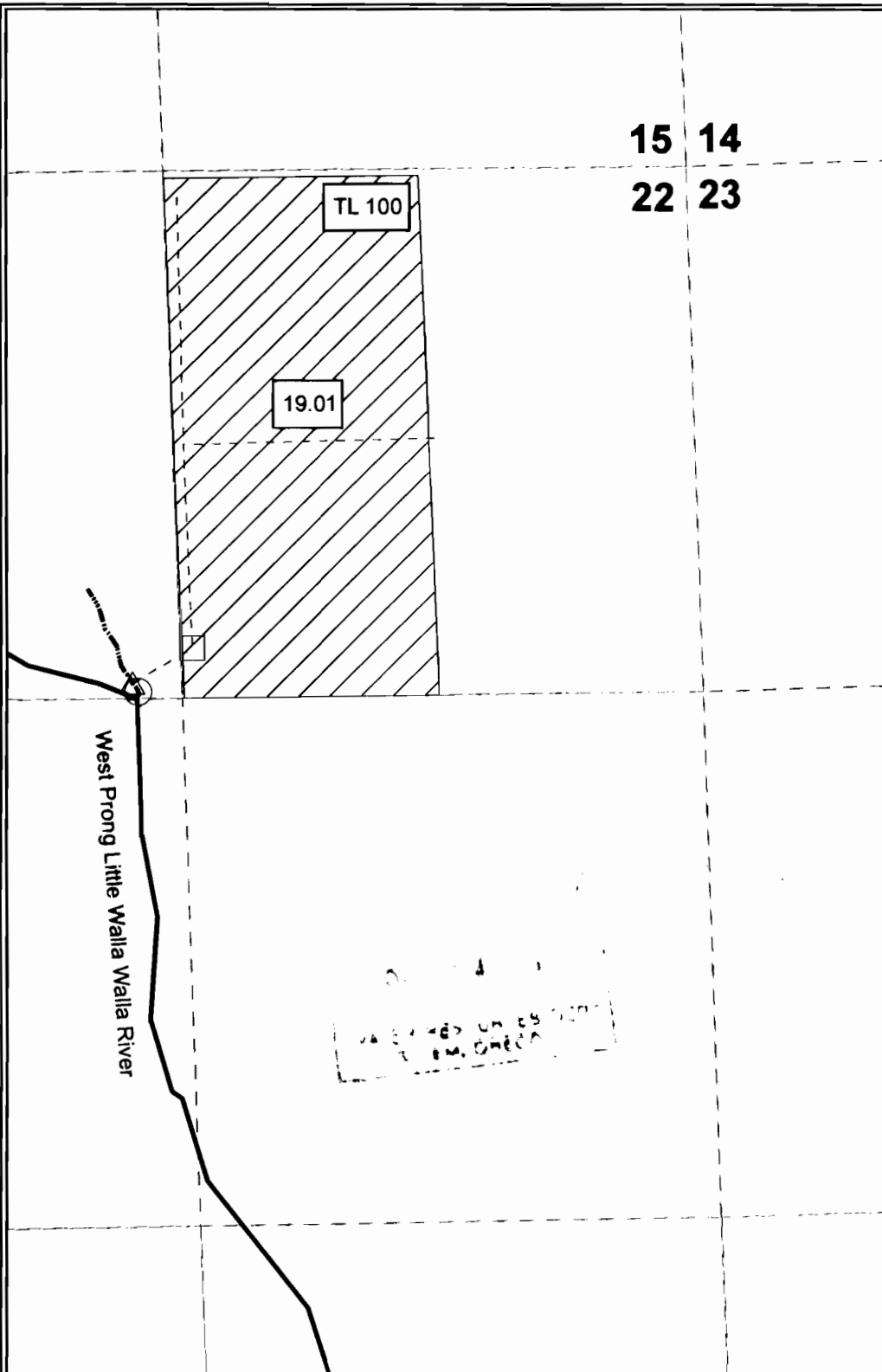

The purpose of this map is to identify the location of a water right. It is not intended to provide information regarding the location of property ownership boundary lines.

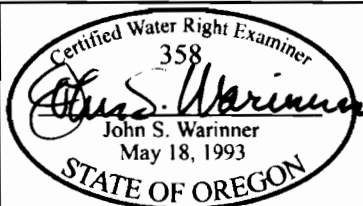

FOUNTAINHEAD
1860 Blue Creek Road
Walla Walla, WA
99362

FINAL PROOF SURVEY
Transfer No. T-8575

in the name of
JIM WALISER ORCHARDS

Revised 21 NOV 2006