

SEC. 15 T.25S. R. 6W W.M.
DOUGLAS COUNTY

WILCOX FAMILY FARM LLC WETLAND ENHANCEMENT
REVISED ON 6-4-97
SEE MAP 25 6 20



SCALE 1" = 660'

RECEIVED

JUN 01 2004

WATER RESOURCES DEPT
SALEM, OREGON

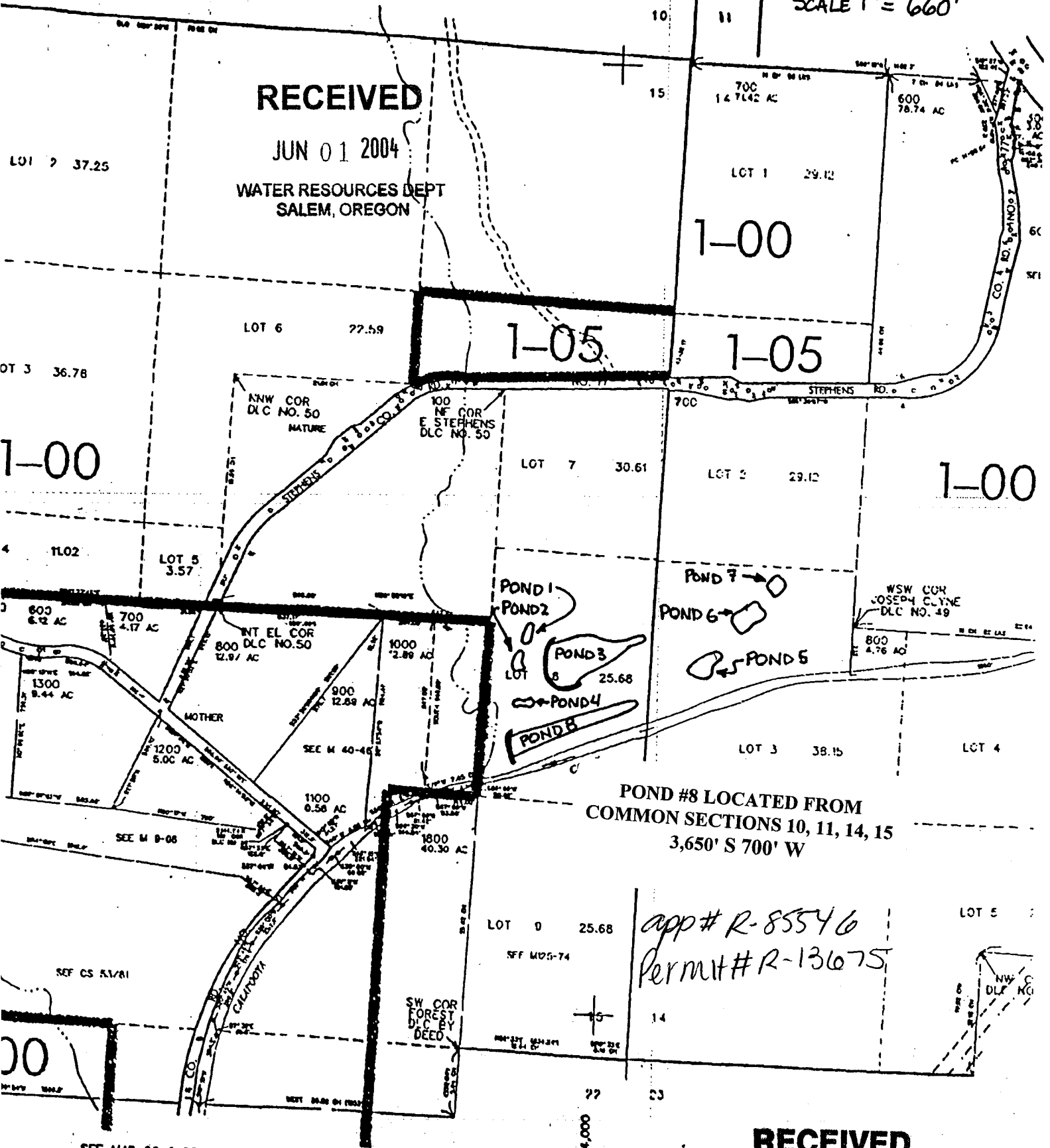

POND #8 LOCATED FROM
COMMON SECTIONS 10, 11, 14, 15
3,650' S 700' W

app # R-85546
Permit # R-13675

RECEIVED

APR 07 2003

WATER RESOURCES DEPT

SEE MAP 25 6 22

4,34,000