

App 3858
Per 2166

E 1/4 NW 1/4 NE 1/4 - 17-1S-10E.W.M.

NE 1/4 SW 1/4 NE 1/4 - 17-1S-10E.W.M.

SE 1/4 NE 1/4 - 17-1S-10E.W.M.

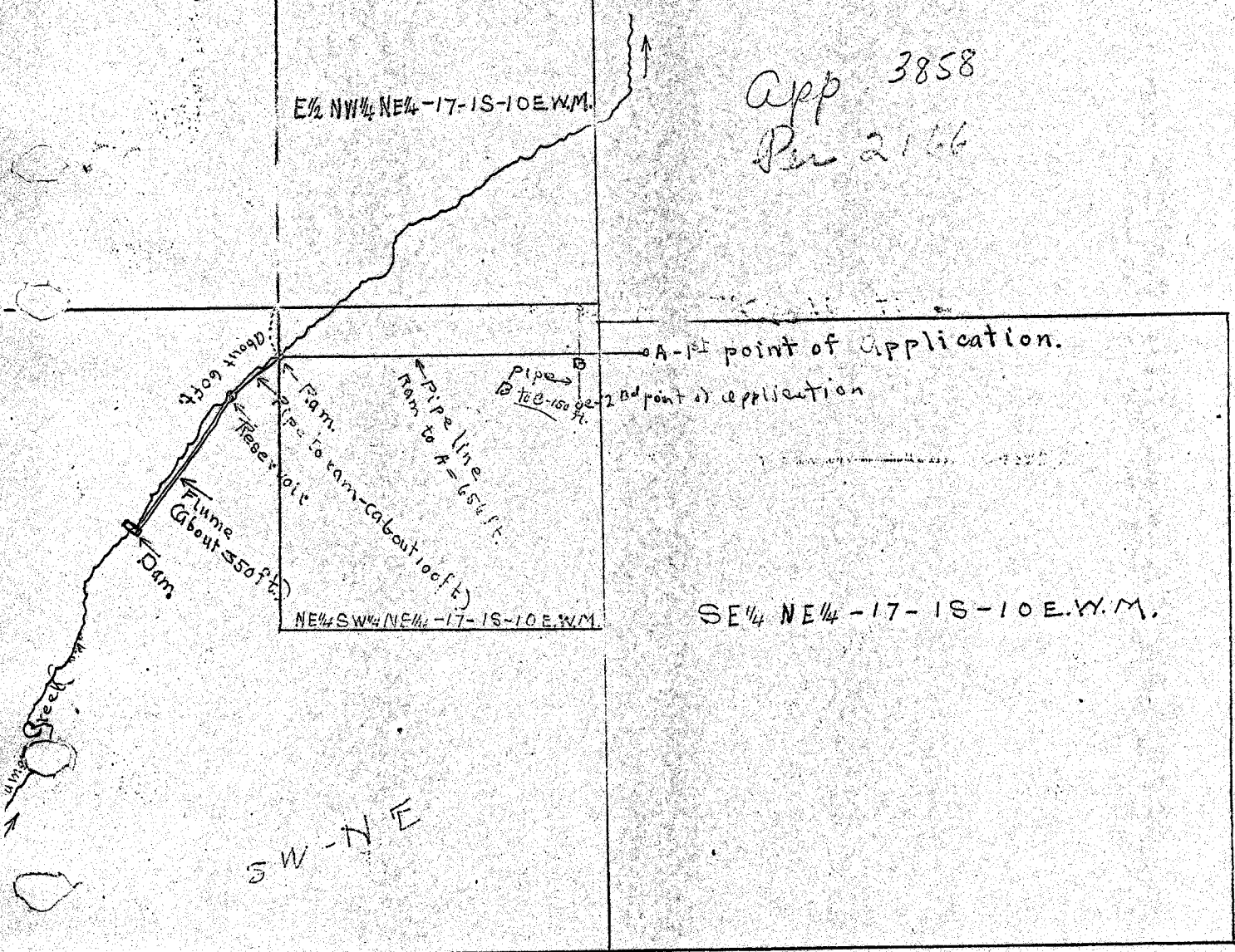

SW-NE

15-10E

OFFICE OF STATE ENGINEER
RECEIVED
AUG 17 1914
SALEM, OREGON.

Application No. 3858
Permit No. 2166