

T. 2N., R. 27E., W.M.

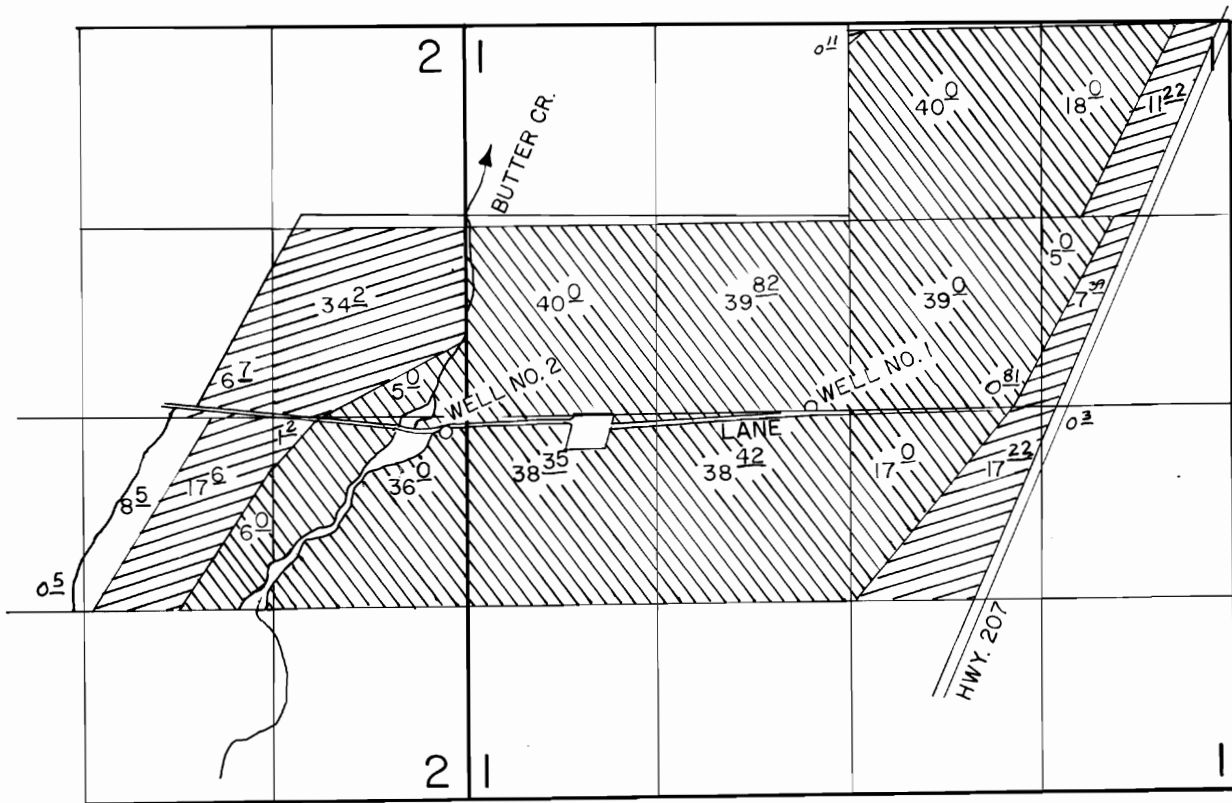

FINAL PROOF SURVEY
UNDER

SUPPLEMENTAL  PRIMARY 
Application No. G-547... Permit No. G-434.....
IN NAME OF

CLAUSIE H., SHELIA, EDWARD N., & ALICE AMMON

Surveyed JULY 21, 1960., by R. H. JACKSON.