

OFFICE OF STATE  
 RECEIVED  
 AUG 15  
 SALEM, ORE.

APR 11

15

16

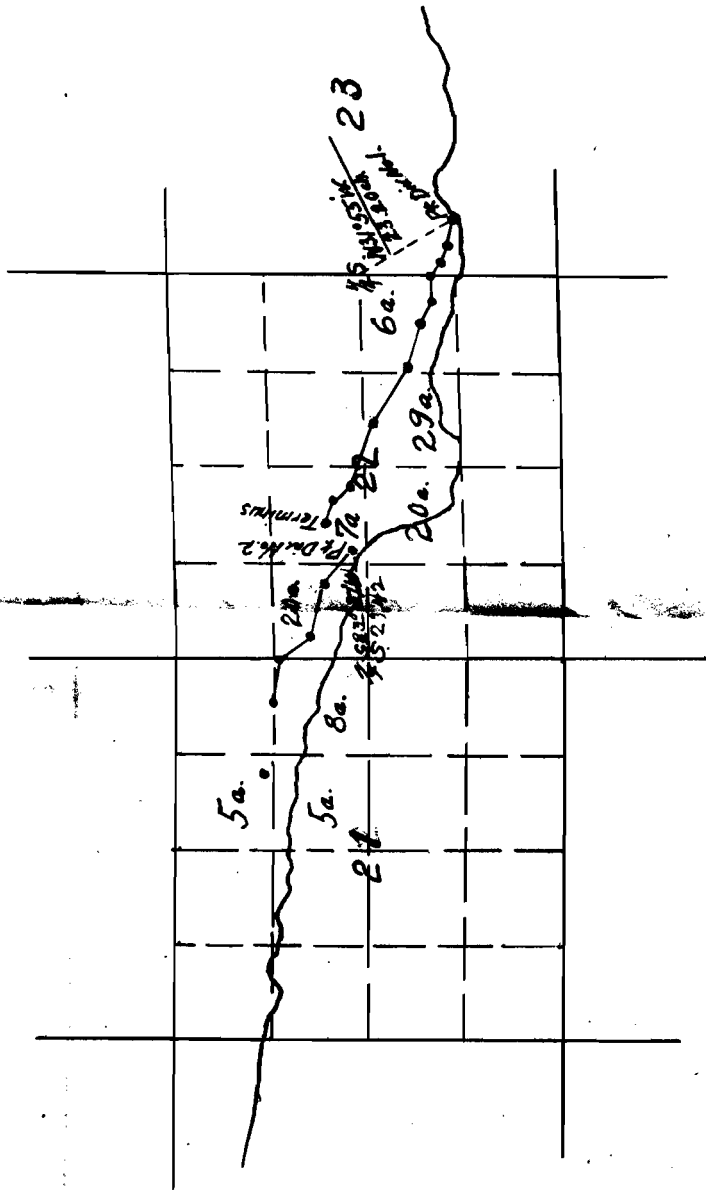

29

29

I, Fred A. Rice, of Pineville, Ore, do hereby certify that this map was made from notes taken during an actual survey by me on July 10<sup>th</sup> & 11, 1913, and that it represents the works described in the accompanying application, together with the location of streams and other ditches in the immediate vicinity, and has written thereon the area in each smallest legal subdivision which it is proposed to irrigate.

Fred A. Rice  
 Surveyor