

G 6770
51594

T.27S. R.17E. W.M.

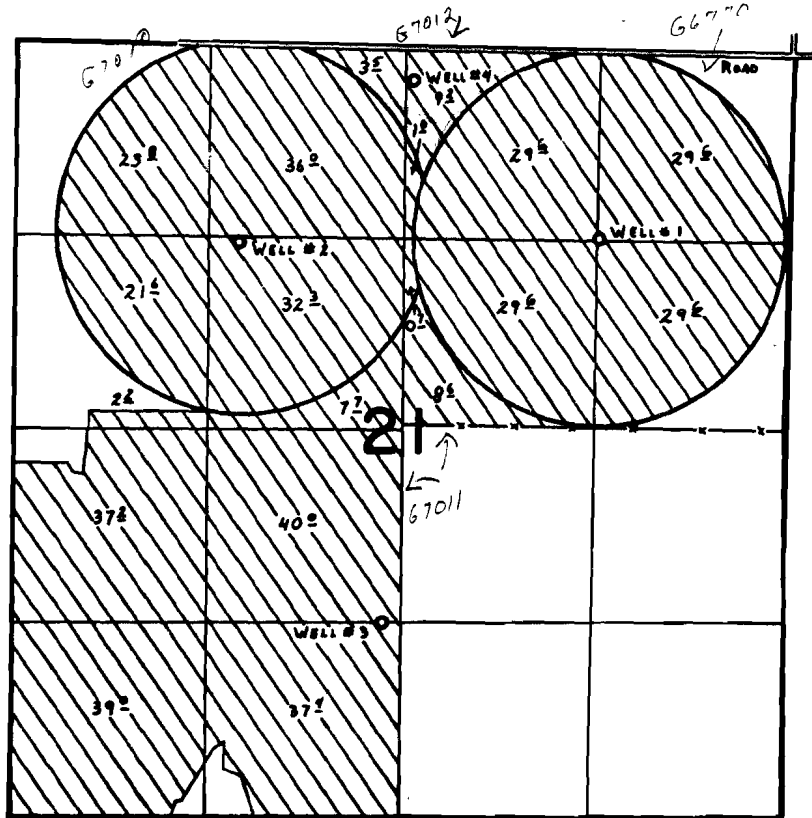

WELLS Loc:
#1- 1280'S. { 1300'W. }
#2- 1350'S. { 3770'W. }
#3- 2920'S. { 2750'W. }
#4- 220'S. { 2610'W. }
ALL FROM N.E. COR. SEC. 21.

FINAL PROOF SURVEY

UNDER

G-7332
G-7539
G-7540

G-6770
G-7010
G-7011

Application No. G-7541. Permit No. G-7012.

IN NAME OF

HASKEL & SHIRLEY A. BLACK

Surveyed Aug. 28, 1978, by S.P. APPLIGATE