

T. 6N., R. 34E., W.M.

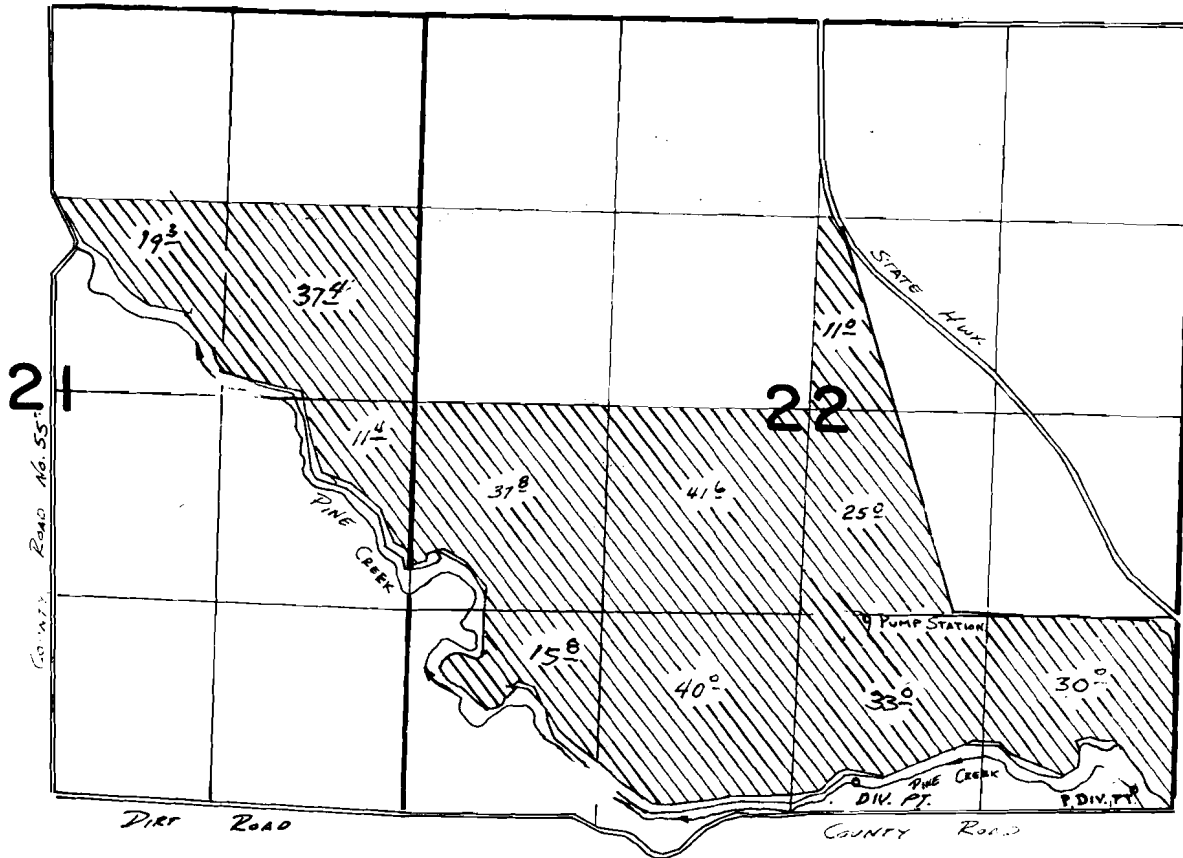

P. Div. Pt. LOCATED: 130 ft. N. and 280 ft. W.; 200 ft. N. and 2200 ft. W;
Both from the SE Corner, Section 22.

FINAL PROOF SURVEY UNDER

Application No. **55009** Permit No. **41319**.....
IN NAME OF

.....**NEAL BLESSINGER**.....

SCALE: 1" = 1320'

Surveyed ~~Jan. 18~~ 1987, by ~~V. L. Church~~.....
SEP 24 1985

To: Steve Braun
From: [unclear]
0901

29779

MAP TO ACCOMPANY TRANSFER APPLICATION
CHANGE IN, AND ADDITIONAL POINTS OF DIVERSION
MODIFYING
PERMIT 29779, CERTIFICATE 39091

T-8720

T. 6 N. R. 34 E. W. M.

SECTIONS 21 AND 22
UMATILLA COUNTY, OREGON
APPLICANT: CALVIN N. BLESSINGER

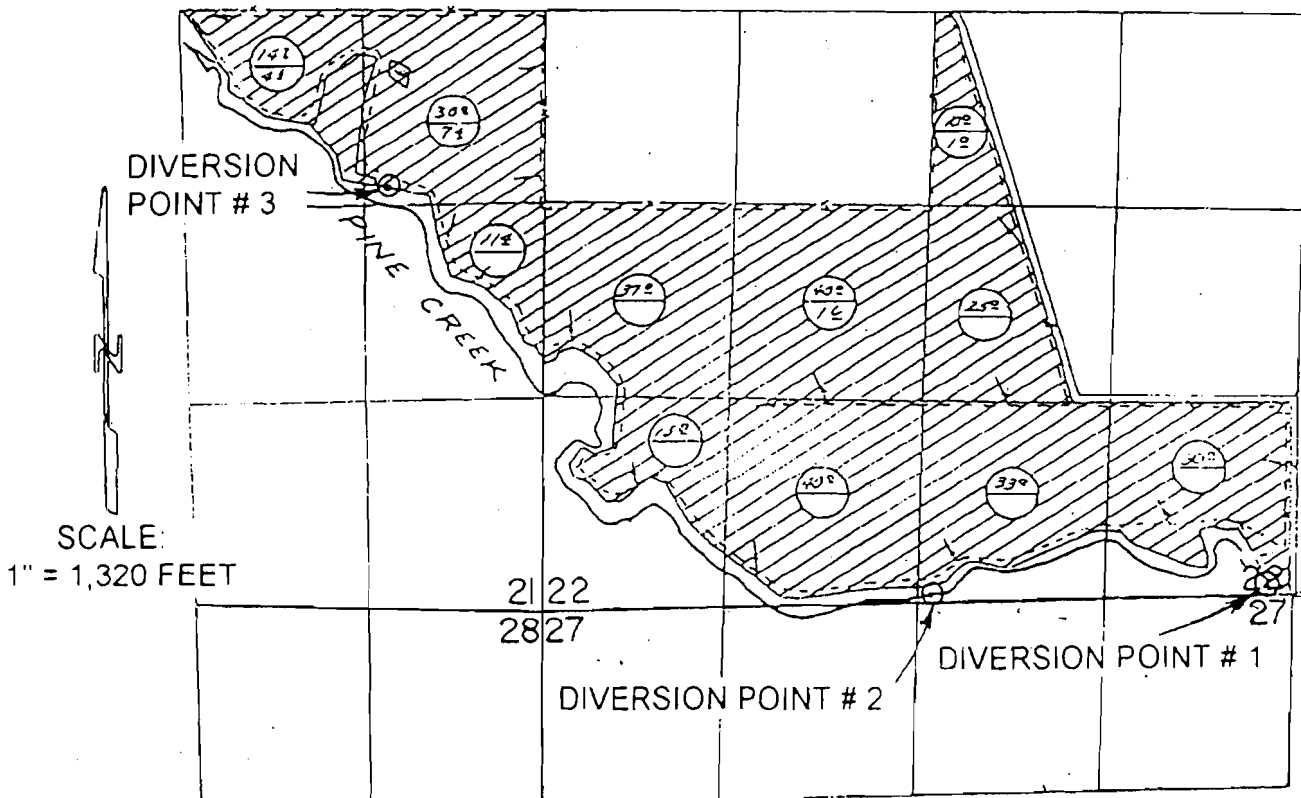

LEGEND

- NEW / ADDITIONAL POINT OF DIVERSION

LOCATION OF PROPOSED POINTS OF DIVERSION

- # 1 40 FEET NORTH AND 275 FEET WEST OF THE SOUTHEAST CORNER OF SECTION 22.
- # 2 2,590 FEET WEST OF THE SOUTHEAST CORNER OF SECTION 22 (ON THE SECTION LINE).
- # 3 2,750 FEET NORTH AND 1,100 FEET WEST OF THE SOUTHEAST CORNER OF SECTION 21.

RECEIVED

MAR 15 2001

WATER RESOURCES DE
SALEM, OREGON

THIS MAP IS PREPARED FOR THE EXPRESS PURPOSE TO SHOW WATER APPROPRIATION AND USE. IT IS NOT INTENDED TO SHOW OR LOCATE PROPERTY

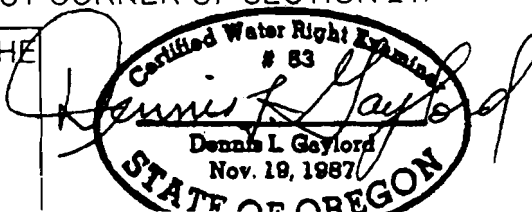

DENNIS L. GAYLORD, CARE
71614 S.W. LAKE DRIVE
PENDLETON, OR 97801
541 - 276 - 6260