

# T.8S., R.4W., W.M.

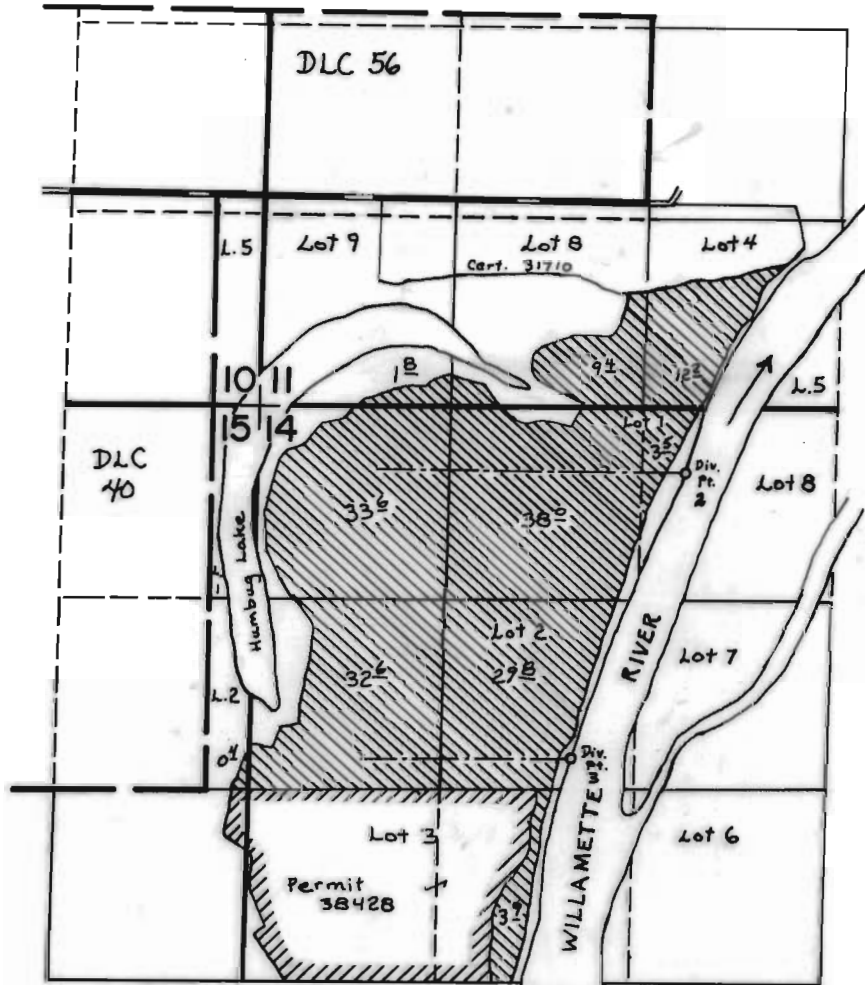

Div. Pts. Located: 2-440'S; 300'E; 3-2420'S; 440'W' from the N 1/4 Cor. Sec. 14

## FINAL PROOF SURVEY UNDER

Application No. 50950 Permit No. 38463

IN NAME OF

MARX FARMS INC

Surveyed MAY 18 1976, by C. KING