

T.36S., R.3W., W.M.

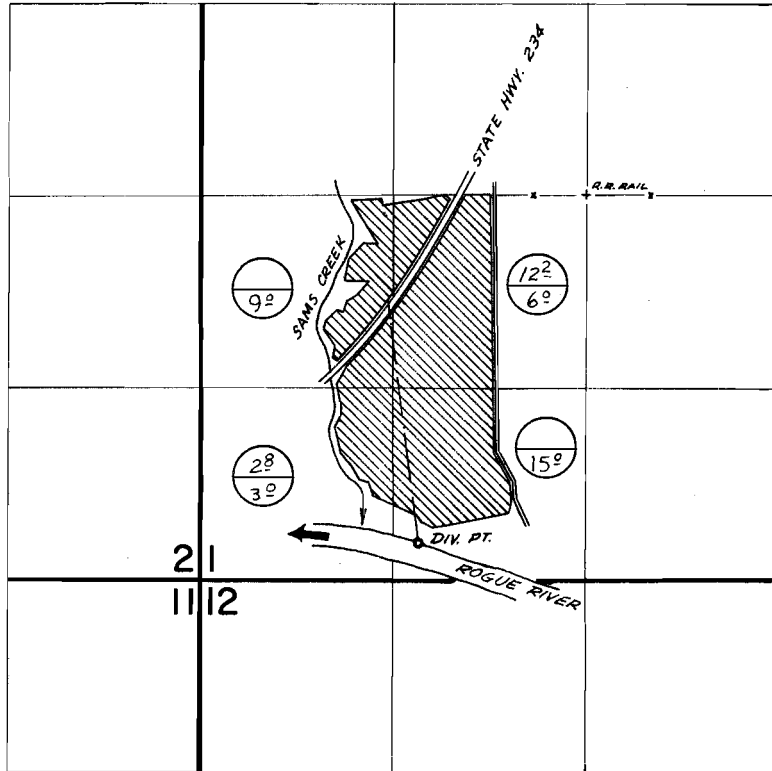

DIV. PT. LOC: 2390'S & 1150' W FROM CENTER SEC. 1

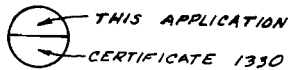

FINAL PROOF SURVEY
UNDER

Application No. 44007 Permit No. 32898
IN NAME OF

JOHN WALSH AND CLAUDE ALLEN

Surveyed May 5 1975, by D. Norby