

FINAL PROOF MAP T-8960  
 NE1/4SW1/4 SECTION 3, T.39S., R.3W., W.M.  
 JACKSON COUNTY, OREGON  
 FOR  
 CARVER AND PATRICIA MOOSMAN  
 2444 UPPER APPLGATE ROAD  
 JACKSONVILLE, OREGON 97530

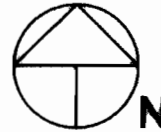
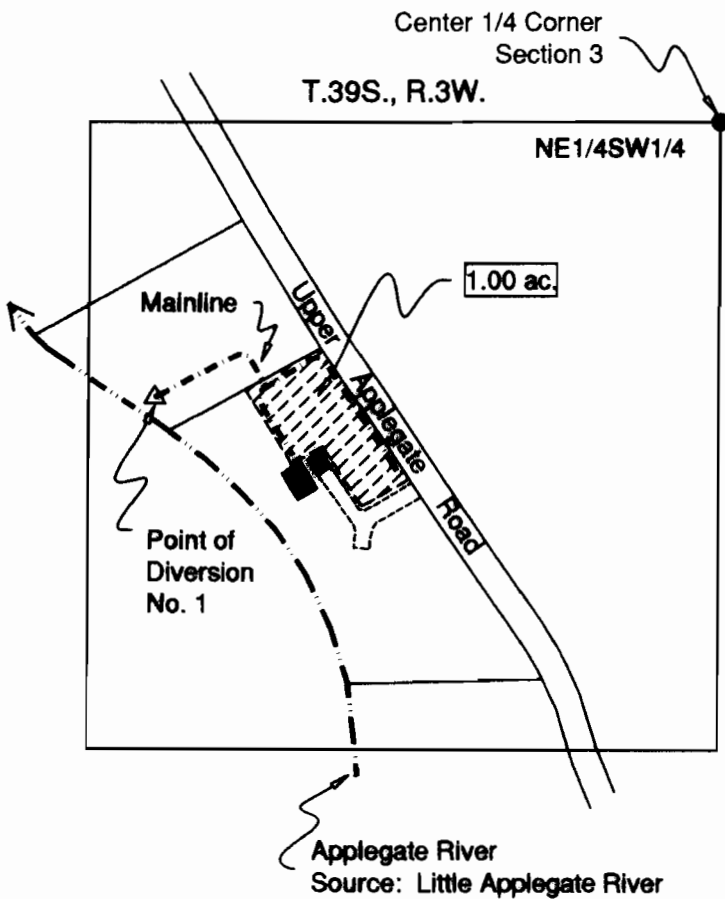

Scale: 1"=400'

Date: September 26, 2005

**LEGEND**

- Found Survey Monument
- Denotes Building
- Denotes Driveway
- - - Denotes Mainline Pipe
- ▨ Denotes Area Under Special Order Volume 59 Pages 408-409

Point of Diversion No. 1 - Situated  
 1180 ft. West and 500 ft. South  
 from Center One-Quarter Corner,  
 Section 3.

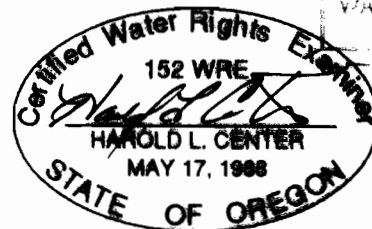
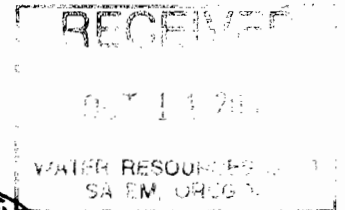

This map was prepared for the purpose of identifying the location of a water right only and is not intended to provide legal dimensions or location of property ownership.

HAROLD L. CENTER  
 2604 David Lane  
 Medford, OR. 97504  
 Phone 541-535-6108  
 Oregon Certificate No. 152  
 Certificate Renewal Date: 12/31/2005

# T 39 S, R 3 W, W.M.

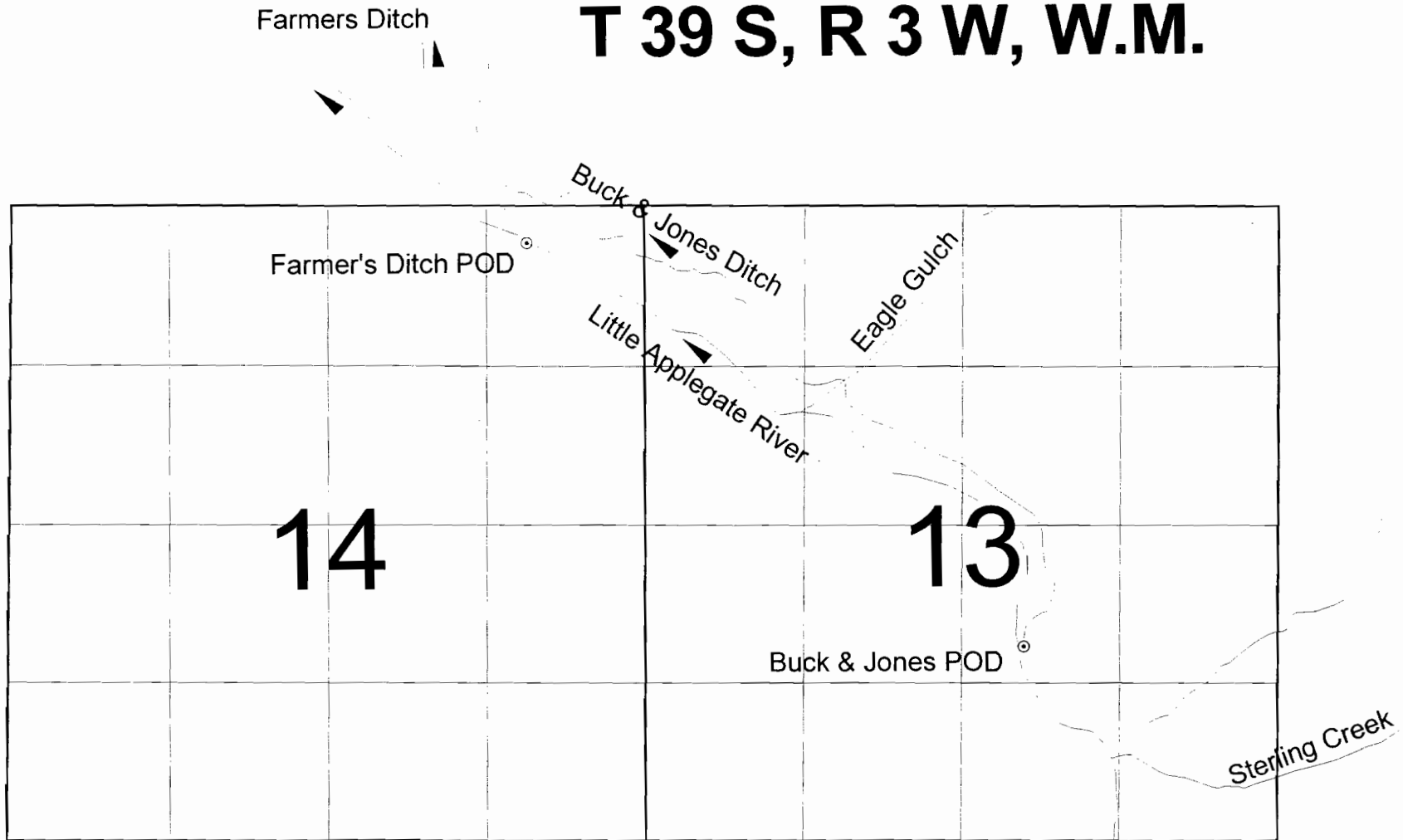

Final Proof Survey  
under  
T-8960

Little Applegate River



Farmer's Ditch POD - GPS coordinates: Latitude 42.18400, Longitude -123.0174  
Buck & Jones Ditch POD - GPS coordinates: Latitude 42.17508, Longitude -123.0018

