

Township 5 South, Range 1 West, W.M.  
Portions of Sections 14 & 15

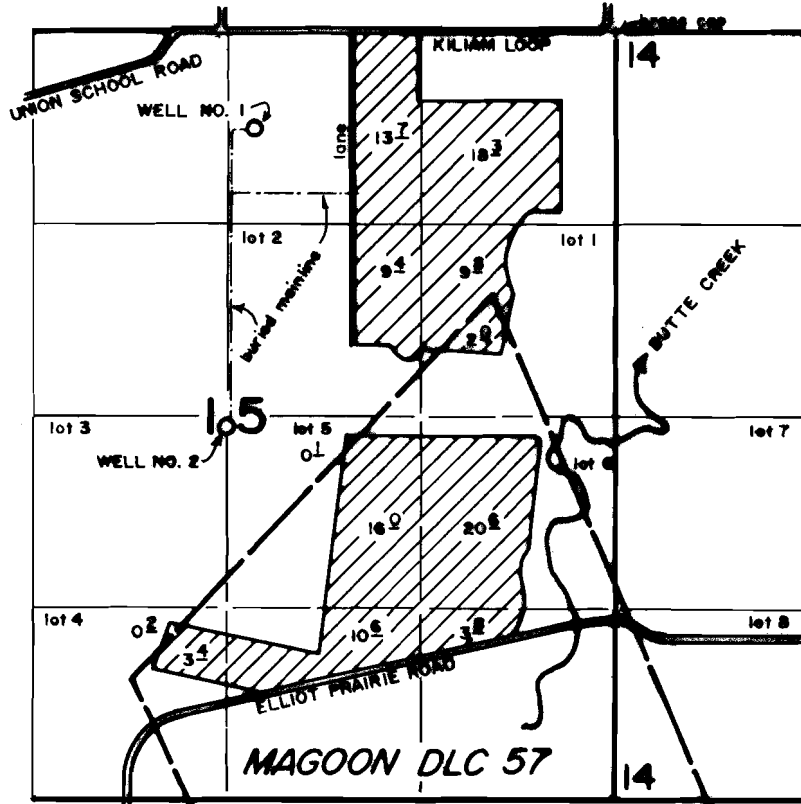

WELLS LOCATED: NO. 1, 670' S. and 2460' W.; NO. 2, 2720' S. and 2640' W.;  
BOTH FROM NE COR. SEC. 15.



**RECEIVED**

APR 14 1995  
WATER RESOURCES DIVISION  
SALE OF LANDS  
STATE OF OREGON

FINAL PROOF SURVEY  
under

Appl. No. G-12799, Per. No. G-11614  
in the name of

**BUTSCH BROS.**

January 20, 1995  
June 2, 1995

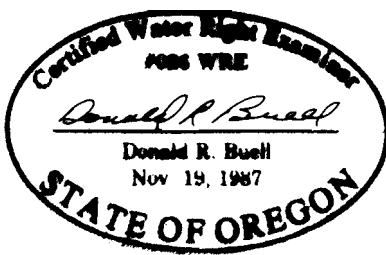

THIS MAP WAS PREPARED FOR THE PURPOSE OF  
IDENTIFYING THE LOCATION OF A WATER RIGHT  
ONLY AND IS NOT INTENDED TO PROVIDE LEGAL  
DIMENSIONS OR LOCATION OF PROPERTY  
OWNERSHIP LINES.