

MAP TO ACCOMPANY GROUND WATER APPLICATION

REFERENCE: FILE #G-13749

SITUATED IN THE S 1/2 S 1/2 OF SECTION 29, AND THE SE 1/4 SE 1/4 OF SECTION 30, T40S, R12E, W1M, KLAMATH COUNTY, OREGON

*Use as Final Proof Map
DC WRD Dec 2, 2005
MAP PREPARED FOR

JULY 1994

RECEIVED

SEP 25 1995

-- WARREN & ANNA HAUGHT --

MAP PREPARED FROM
WATER RESOURCES DEPT.
-- APPLICATION MAP SUPPLEMENTAL TO K.B.L.D. --
-- ASSESSORS MAP SALEM, OREGON



SCALE
1" = 1320'

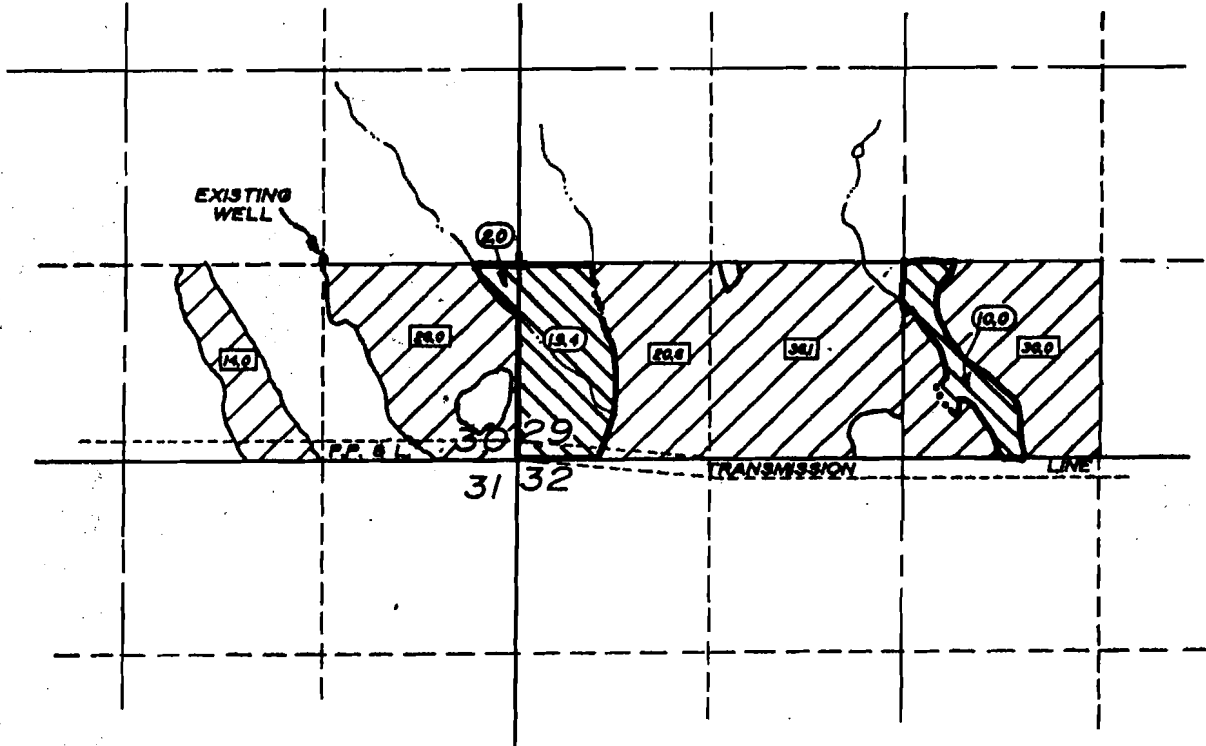

LOCATION OF EXISTING WELL BY OWNER

1330 FEET NORTH AND 1320 FEET WEST OF
THE SOUTHEAST CORNER OF SECTION 30

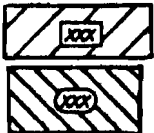

LANDS SUPPLEMENTAL TO K.B.L.D. - SEE
APPLICATION MAP DATED JANUARY 1994

PRIMARY LANDS THIS APPLICATION

TOTAL AREA THIS APPLICATION

-- 31.4 Ac. --

Application No. G 13749
Permit No. G12862

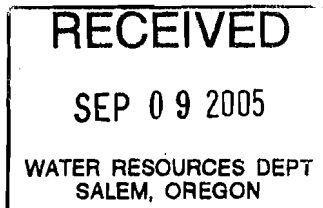
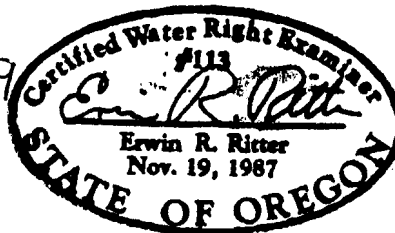

THE PURPOSE OF THIS MAP IS TO IDENTIFY THE LOCATION OF THE
WATER RIGHT. IT IS NOT INTENDED TO PROVIDE INFORMATION RELATIVE TO
THE LOCATION OF PROPERTY OWNERSHIP BOUNDARY LINES.

TRU-LINE SURVEYING
2333 SUMMERS LANE
KLAMATH FALLS, OR, 97603