

T.4S., R.1W., W.M.

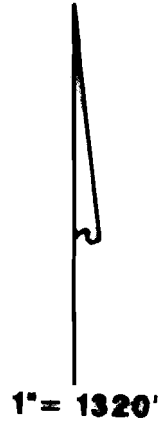
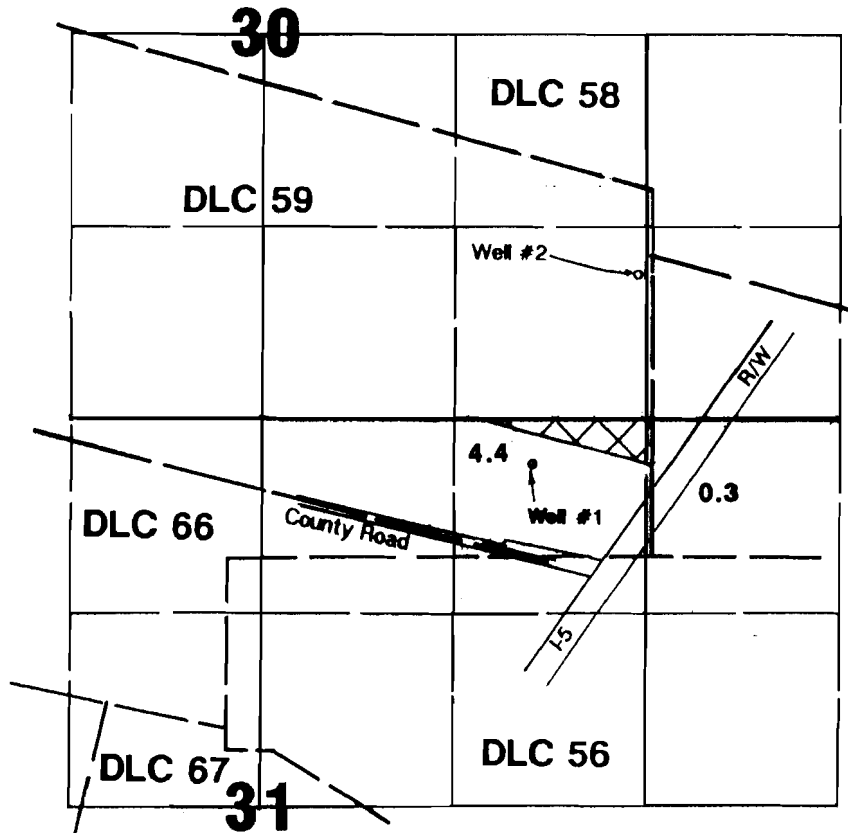

Well #2 (add'l POA) located 1000'N & 50'W from SE corner Section 30.
 Well #1 located 607'N & 12'W from SE corner DLC 59.

*812'
 JL
 8/16/2005*

RECEIVED

JAN 29 1996

WATER RESOURCES DEPT
 SALEM, OREGON

Final Proof Survey

Transfer: T-6488

In Name Of

Jesse C. Owre

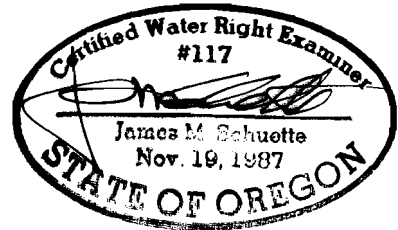

Surveyed on December 5, 1995 by JM Schuette

THIS MAP WAS PREPARED FOR THE PURPOSE OF IDENTIFYING THE LOCATION OF A WATER RIGHT ONLY AND IS NOT INTENDED TO PROVIDE LEGAL DIMENSIONS OR LOCATION OF PROPERTY OWNERSHIP LINES.