

CLAIM OF BENEFICIAL USE MAP

UNDER APPLICATION R-85141 ; PERMIT R-13384

SW1/4 SW1/4 SEC 24 T 23S R 40E W.M.

U.S.G.S. QUAD - ALDER CREEK, OREG. - 7 1/2'

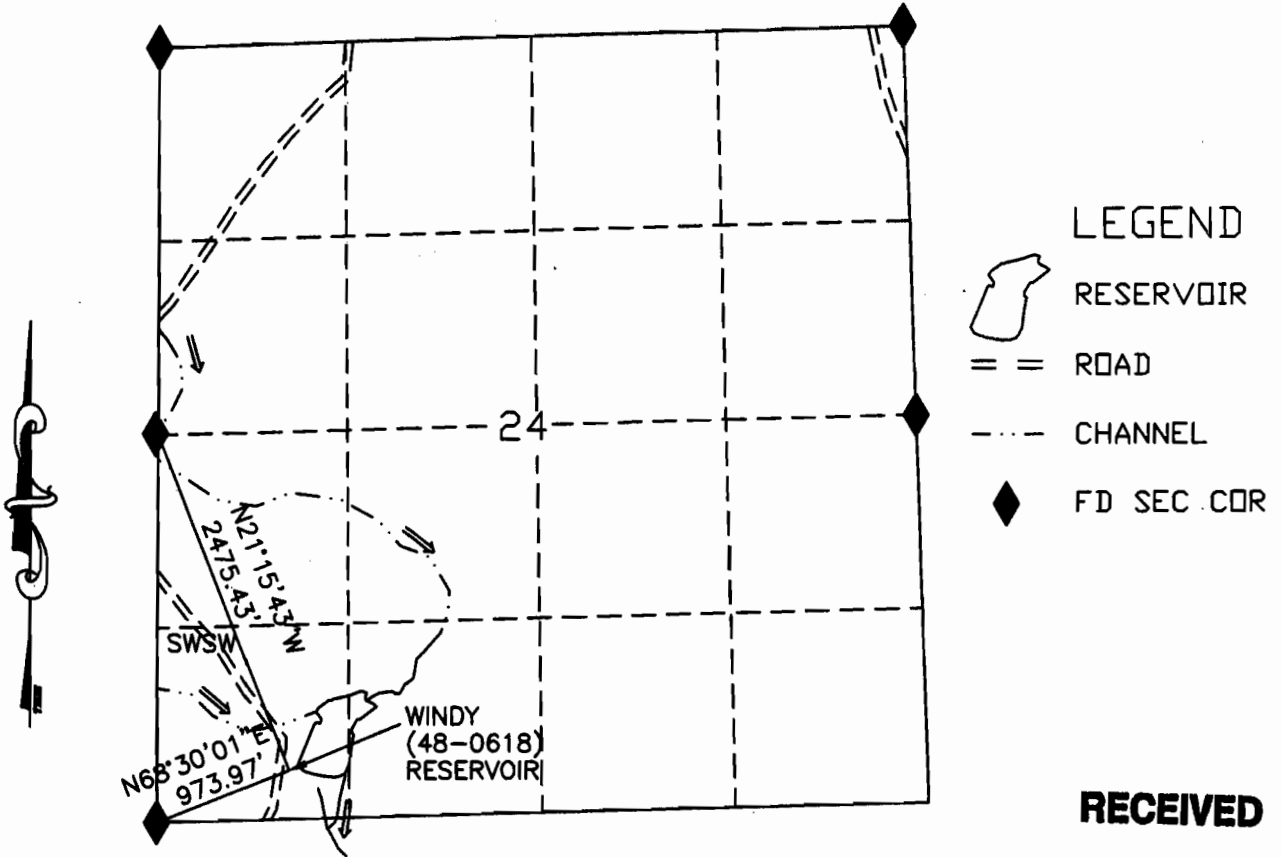

RECEIVED

JAN 06 2006

WATER RESOURCES DEPT
SALEM, OREGON

WINDY (48-0618) RESERVOIR

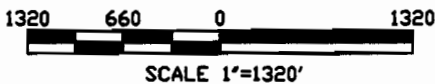

I, Charles E. Joy, Administrative Officer, Vale BLM agree to the findings of the CWRE and do submit this site report and map as my Claim of Beneficial Use of the water as provided under the terms and conditions of my Permit R-13384

Cathy Erlinger (acting)



THIS MAP IS FOR THE PURPOSE OF LOCATING A WATER RIGHT AND IS NOT INTENDED TO PROVIDE LEGAL DIMENSIONS FOR LOCATION OF PROPERTY BOUNDARIES.

ACAD2005
DWG FILE: WINDY-BENE

UNITED STATES DEPARTMENT OF THE INTERIOR BUREAU OF LAND MANAGEMENT DIVISION OF OPERATIONS VALE DISTRICT	
WINDY (48-0618) RESERVOIR	
DESIGNED:	
REVIEWED:	
APPROVED:	<i>Cathy Erlinger (acting)</i> ADM OPERATIONS AND FIELD SERVICES
DRAWN: CG	SCALE: 1"=1320'
DATE: 12/14/05	SHEET 1 OF 1
DRAWING NO. OR-03-9172.45-1249	