

RECEIVED  
AUG 02 2001  
WATER RESOURCES DEPT  
SALEM, OREGON

T. 38 S., R. 13 E., W.M.

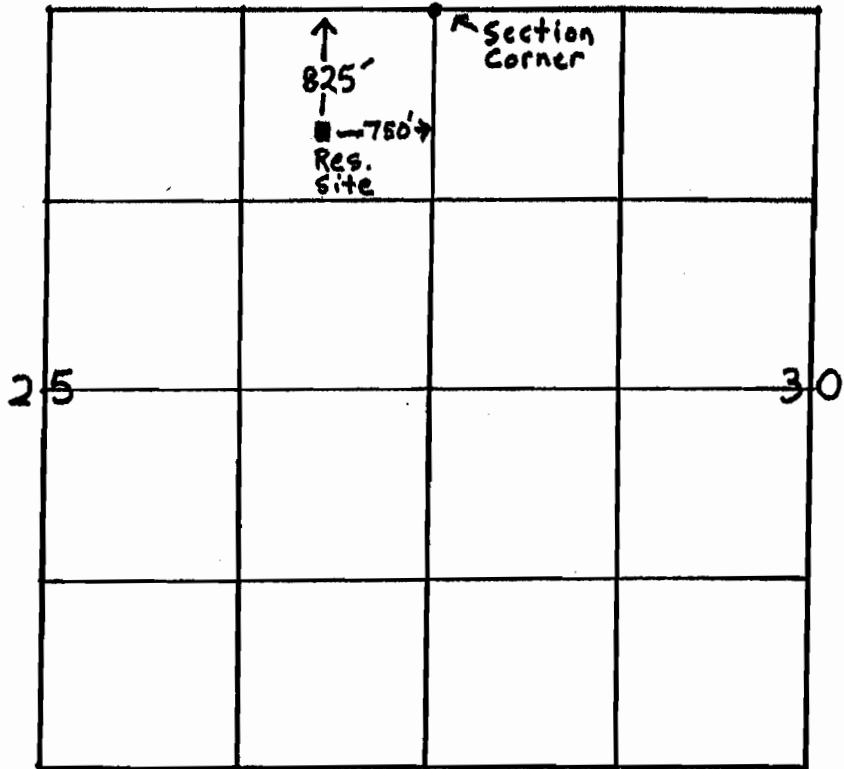

Application No. *R84824*  
Permit No. *R-13397*  
N ↑  
1" = 1320'

Application Map  
For  
Oatgrass Waterhole  
In Name Of  
United States Bureau of Land Management  
Lakeview District

RECEIVED  
MAY 20 2004  
WATER RESOURCES DEPT  
SALEM, OREGON

The purpose of this map is for identifying the location of the water right only and is not intended to provide legal dimensions or location of property ownership lines.

*Dana J. Fisher*