

T. 1N., R. 13E., W.M.

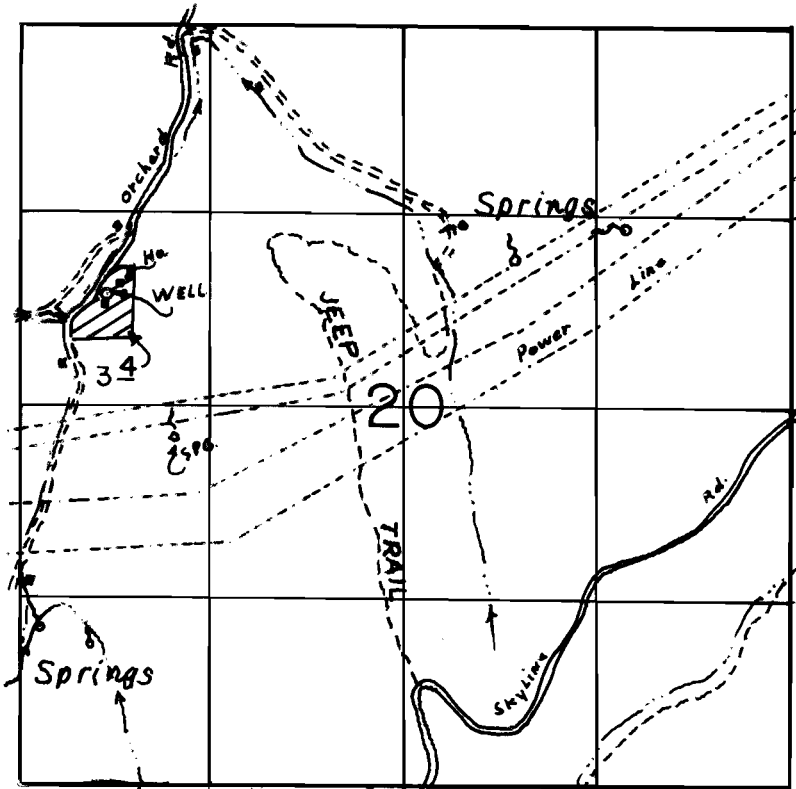

WELL LOC: 550'S & 700'E FROM NW COR. OF SW 1/4, NW 1/4 SEC 20.

SCALE: 1" = 1320'

FINAL PROOF SURVEY
UNDER

Application No. G-11528 Permit No. G-10647..
IN NAME OF

.....ALFRED L. HAYES.....

Surveyed MAY. 15. 1995, by R.M. SUTTERFIELD