

T. 2 N., R. 11 E., W.M.

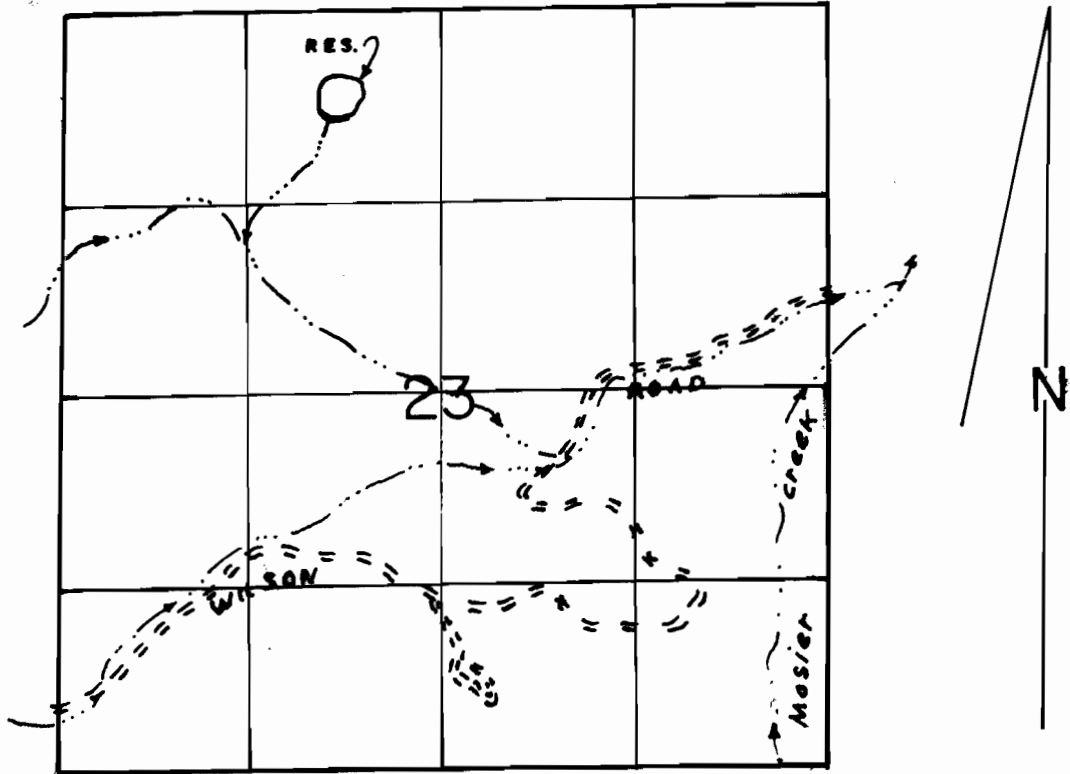

RES. LOC: IN THE NE 1/4, NW 1/4 OF SEC 23.

SCALE: 1" = 1320'

FINAL PROOF SURVEY
UNDER

Application No. R-64132 Permit No. R-8524
IN NAME OF

F. RICHARD SCHNEIDER

Surveyed APRIL 25 1995, by R.M. SUTTERFIELD