

T 1 N  
R 13 E

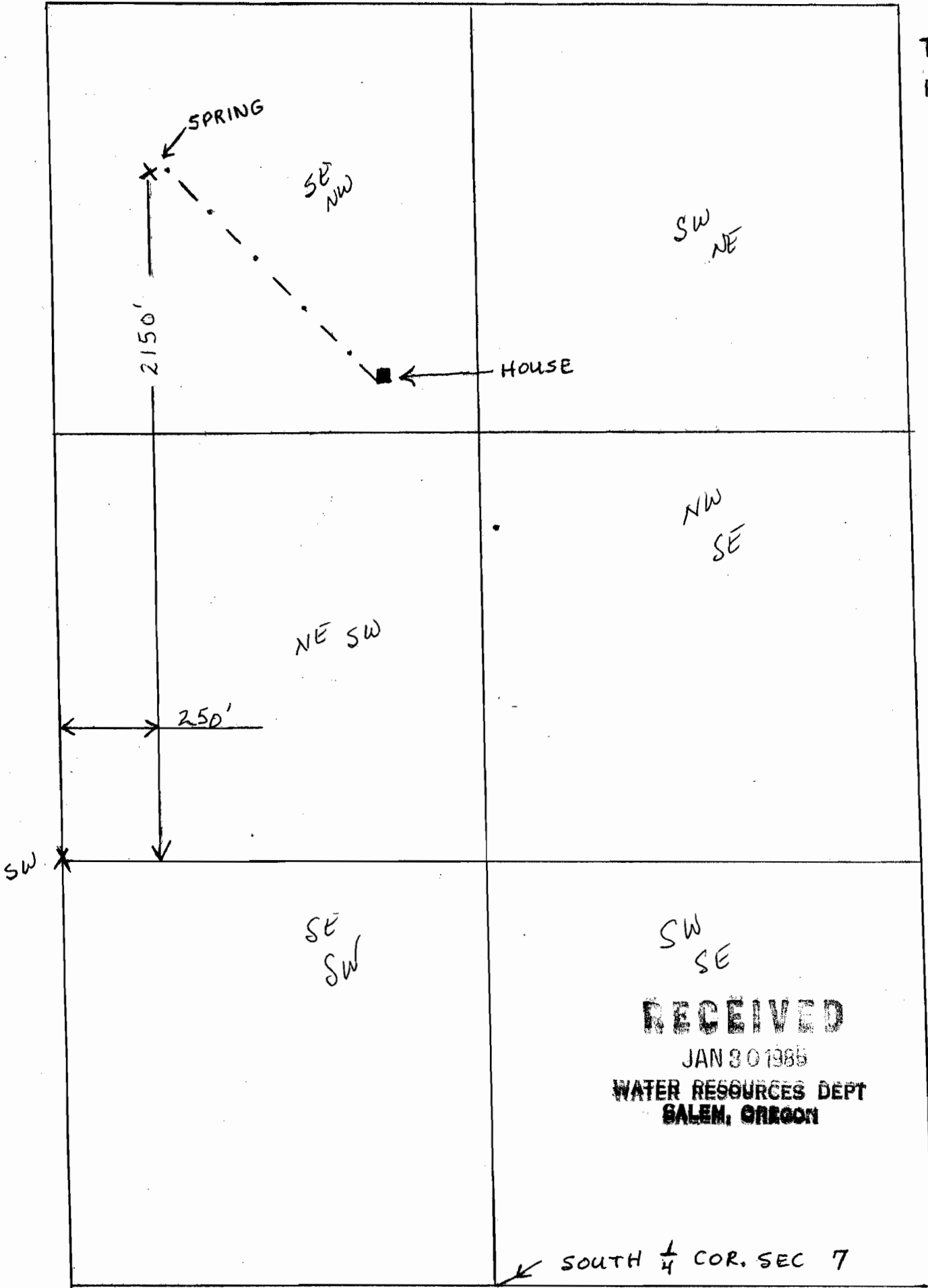

Application No. 68267

Permit No. 49246

**RECEIVED**

JAN 30 1985

WATER RESOURCES DEPT  
SALEM, OREGON

← SOUTH 1/4 COR. SEC 7

SCALE 1" = 400'

Dimensions per Field Inspection  
Report 2/6/92  
TWS 3/27/06