

0184

FINAL PROOF MAP T-8962  
 NE1/4SW1/4, SECTION 3  
 T.39S., R.3W., W.M.  
 JACKSON COUNTY, OREGON  
 FOR  
 HOBART AND NANETTE MARVIN  
 2557 UPPER APPLGATE ROAD  
 JACKSONVILLE, OREGON 97530

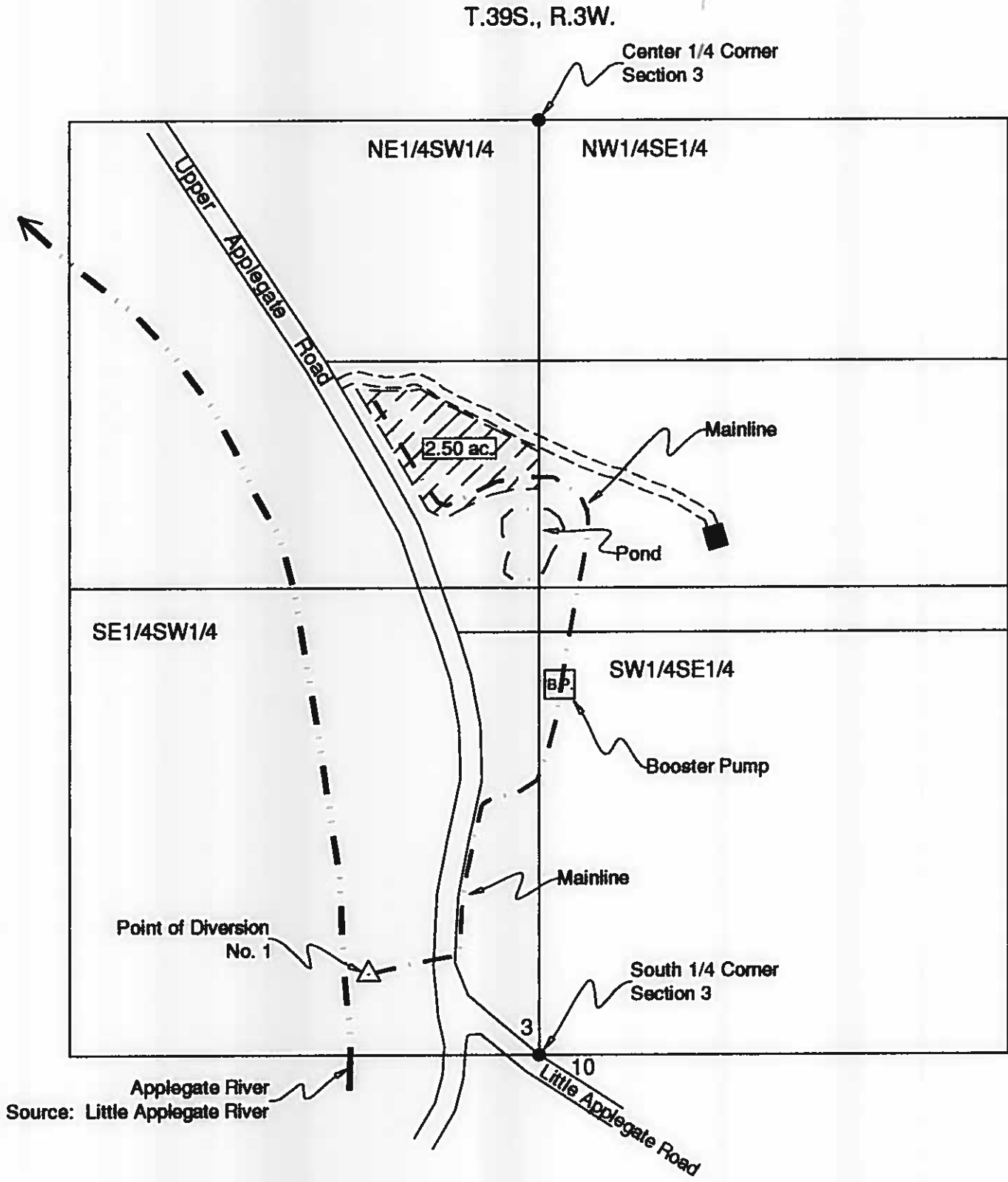

COBU MAP # 0184



Scale: 1"=400'  
 Date: September 30, 2005

**LEGEND**

- Found Survey Monument
- Denotes Building
- Denotes Driveway
- - - Denotes Mainline Pipe
- ▨ Denotes Area Under Special Order Volume 39 Pages 398-401

Point of Diversion No. 1 - Situated 480 ft. West and 230 ft. North from South One-Quarter Corner, Section 3.

This map was prepared for the purpose of identifying the location of a water right only and is not intended to provide legal dimensions or location of property ownership.

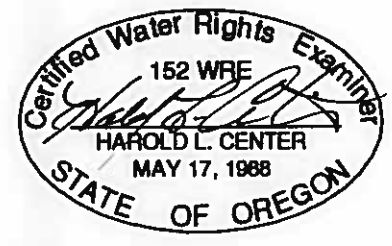

HAROLD L. CENTER  
 2604 David Lane  
 Medford, OR. 97504  
 Phone 541-535-6108  
 Oregon Certificate No. 152  
 Certificate Renewal Date: 12/31/2005

RECEIVED  
 OCT 13 2005  
 WATER RESOURCES DEPT  
 SALEM, OREGON